

Section 6

ecoFIT[®] Industrial Polyethylene Piping System



Pricing effective January 1, 2017



ecoFIT Metric PE

212

ecoFIT Metric PE

ecoFIT Pipe

A

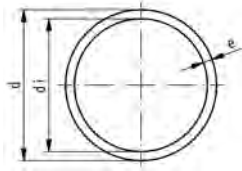

ecoFIT pipe SDR11

Model:

- Material: PE100
- Color: Black
- Dimension: DIN 8074
- Pipe length: 5m, with plain ends

d (mm)	PN (bar)	Part No.	USD / m	e (mm)	di (mm)
20	16	193 017 156	2.30	1.9	16.2
25	16	193 017 157	5.60	2.3	20.4
32	16	193 017 158	5.70	2.9	26.2
40	16	193 017 159	8.90	3.7	32.6
50	16	193 017 160	11.10	4.6	40.8
63	16	193 017 161	17.40	5.8	51.4
75	16	193 017 162	22.60	6.8	61.4

A

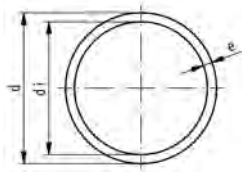

ecoFIT pipe SDR17.5

Model:

- Material: PE100
- Color: Black
- Dimension: DIN 8074
- Pipe length: 5m, with plain ends

d (mm)	PN (bar)	Part No.	USD / m	weight (kg/m)	e (mm)	di (mm)
90	10	193 017 113	18.30	1.400	5.1	79.8
110	10	193 017 114	27.50	2.100	6.3	97.4
160	10	193 017 117	57.50	4.400	9.1	141.8
225	10	193 017 120	95.80	8.640	12.8	199.4
250	10	193 017 121	118.70	10.700	14.2	221.6

ecoFIT

A



Coupler With integral pipe fixation

- PE 100 SDR 11
- 4mm pin connectors
- Limited path fusion indicators
- Removable center stop

d (mm)	Part No.	USD	d1 (mm)	L (mm)
20	753 911 606	6.10	31	70
25	753 911 607	6.90	36	70
32	753 911 608	7.40	44	72
40	753 911 609	7.80	54	80
50	753 911 610	12.00	66	88
63	753 911 611	12.70	81	96

A



Coupler

- PE 100 SDR 11
- 4mm pin connectors
- Limited path fusion indicators
- Removable centre stop up to d160

d (mm)	Part No.	USD	GP weight (kg)	d1 (mm)	L (mm)
75	753 911 612	17.80	12	0.282	96 110
90	753 911 613	23.60	10	0.406	113 125
110	753 911 614	28.90	5	0.692	138 145
160	* 753 911 617	52.60	6	1.362	196 180
225	* 753 911 620	77.30	3	3.329	273 225
250	* 753 911 621	89.70	2	4.678	304 248

A



Elbow 90° With integral pipe fixation

- PE 100 SDR 11
- 4mm pin connectors
- Limited path fusion indicators

d (mm)	Part No.	USD	weight (kg)	d1 (mm)	L (mm)	L1 (mm)	z (mm)
20	753 101 606	19.20	0.080	35	54	34	20
25	753 101 607	19.20	0.068	35	54	34	20
32	753 101 608	19.90	0.098	44	53	36	17
40	753 101 609	24.00	0.141	54	62	39	23
50	753 101 610	30.10	0.200	66	71	43	28
63	753 101 611	34.20	0.318	81	81	48	32

A

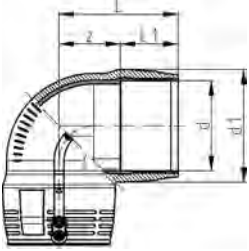

Elbow 90°

- PE 100 SDR 11
- 4mm pin connectors
- Limited path fusion indicators

d (mm)	Part No.	USD weight (kg)	d1 (mm)	L (mm)	L1 (mm)	z (mm)
75	753 101 612	51.30	97	94	54	40
90	753 101 813	60.60	115	122	62	60
110	753 101 814	88.00	140	147	72	76
160	753 101 817	240.30	196	191	92	103

A

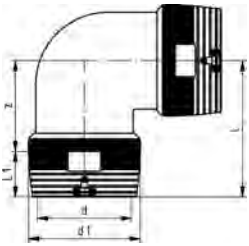

Elbow 90°

- PE 100 SDR 11
- 4mm pin connectors
- Limited path fusion indicators
- Two separate fusion zones

d (mm)	Part No.	USD weight (kg)	d1 (mm)	L (mm)	L1 (mm)	z (mm)
225	753 101 820	765.10	280	318	112	206
250	753 101 821	994.00	310	347	123	224

A

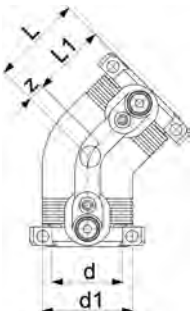

Elbow 45° With integral pipe fixation

- PE 100 SDR 11
- 4mm pin connectors
- Limited path fusion indicators

d (mm)	Part No.	USD weight (kg)	d1 (mm)	L (mm)	L1 (mm)	z (mm)
32	753 151 608	19.90	44	44	36	8
40	753 151 609	24.00	54	50	39	11
50	753 151 610	30.00	66	56	43	13
63	753 151 611	34.20	81	63	48	15

A



Elbow 45°

- PE 100 SDR 11
- 4mm pin connectors
- Limited path fusion indicators

d (mm)	Part No.	USD weight (kg)	d1 (mm)	L (mm)	L1 (mm)	z (mm)
75	753 151 612	65.00	97	71	54	17
90	753 151 813	60.70	115	91	62	29
110	753 151 814	88.00	140	112	72	40
160	753 151 817	240.30	196	135	92	42

A

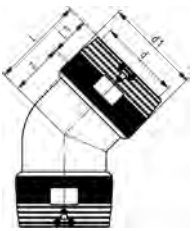

Elbow 45°

- PE 100 SDR 11
- 4mm pin connectors
- Limited path fusion indicators
- Two separate fusion zones

d (mm)	Part No.	USD weight (kg)	d1 (mm)	L (mm)	L1 (mm)	z (mm)
225	753 151 820	765.10	280	247	112	135
250	753 151 821	994.00	310	275	123	152

A

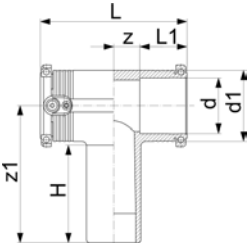

Tee 90° equal With integral pipe fixation

- PE 100 SDR 11
- 4mm pin connectors
- Limited path fusion indicators

d (mm)	Part No.	USD weight (kg)	d1 (mm)	L (mm)	L1 (mm)	z (mm)	z1 (mm)	H (mm)
20	753 211 606	20.90	35	88	32	11	92	67
25	753 211 607	20.90	35	90	32	11	92	70
32	753 211 608	20.90	44	102	34	15	100	74
40	753 211 609	24.00	54	119	39	21	114	82
50	753 211 610	30.40	66	135	42	24	126	90
63	753 211 611	34.80	81	151	46	28	150	102

A

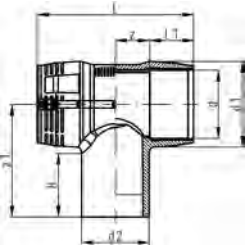

Tee 90° equal

- PE 100 SDR 11
- 4mm pin connectors
- Limited path fusion indicators

d (mm)	Part No.	USD weight (kg)	d1 (mm)	L (mm)	L1 (mm)	z (mm)	z1 (mm)	H (mm)	
75	753 211 612	47.80	0.569	97	178	54	35	143	87
90	753 201 813	56.90	0.891	115	205	62	41	161	94
110	753 201 814	89.60	1.576	140	255	72	56	184	104
160	753 201 817	210.00	4.386	196	325	92	71	206	103

A

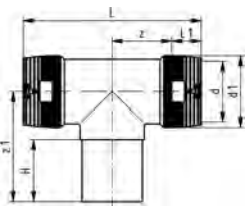

Tee 90° equal

- PE 100 SDR 11
- 4mm pin connectors
- Limited path fusion indicators
- Two separate fusion zones

d (mm)	Part No.	USD weight (kg)	d1 (mm)	L (mm)	L1 (mm)	z (mm)	z1 (mm)	H (mm)	
225	753 201 820	794.00	15.900	280	636	112	206	270	122
250	753 201 821	1,036.00	18.900	310	685	123	220	288	127

A

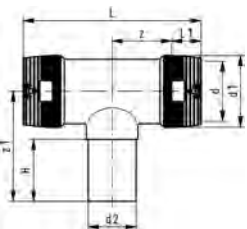

Tee 90° reduced

- PE 100 SDR 11
- 4mm pin connectors
- Limited path fusion indicators
- Two separate fusion zones

d (mm)	d2 (mm)	Part No.	USD weight (kg)	d1 (mm)	L (mm)	L1 (mm)	z (mm)	z1 (mm)	H (mm)	
110	90	753 211 034	166.20	1.652	140	255	72	56	245	80
160	63	753 211 037	565.10	5.660	200	493	90	127	176	65
160	90	753 211 039	565.10	5.508	200	492	90	158	188	79
160	110	753 211 040	565.10	5.157	200	491	90	158	195	85
225	90	753 211 069	1,186.60	13.100	280	666	112	217	226	80
225	110	753 211 070	1,186.60	13.100	280	670	112	217	235	85
225	160	753 211 073	1,186.60	13.600	280	667	112	217	255	105
250	110	753 211 080	1,372.10	11.660	310	709	123	220	245	85
250	160	753 211 083	1,372.10	17.070	310	711	123	220	264	101

A

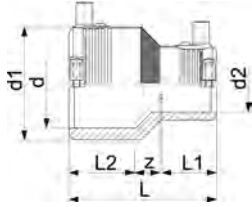

Reducer With integral pipe fixation

- PE 100 SDR 11
- 4mm pin connectors
- Limited path fusion indicators

d (mm)	d2 (mm)	Part No.	USD	weight (kg)	d1 (mm)	L (mm)	L1 (mm)	L2 (mm)	z (mm)
25	20	753 901 639	13.70	0.051	35	74	34	34	6
32	20	753 901 640	13.70	0.056	44	79	33	36	10
32	25	753 901 641	13.70	0.062	44	79	33	36	10
40	20	753 901 644	18.10	0.069	54	88	33	39	15
40	25	753 901 645	18.10	0.084	54	88	33	39	15
40	32	753 901 646	17.60	0.095	54	88	33	39	13
50	32	753 901 651	22.00	0.124	66	96	35	43	18
50	40	753 901 652	24.30	0.119	66	96	39	43	14
63	32	753 901 656	26.20	0.158	81	105	35	48	23
63	40	753 901 657	26.20	0.176	81	105	39	48	19
63	50	753 901 658	26.20	0.176	81	105	43	48	15

A

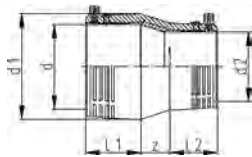

Reducer

- PE 100 SDR 11
- 4mm pin connectors
- Limited path fusion indicators

d (mm)	d2 (mm)	Part No.	USD	weight (kg)	d1 (mm)	L (mm)	L1 (mm)	L2 (mm)	z (mm)
90	63	753 901 831	45.20	0.385	113	146	63	47	36
110	90	753 901 833	68.50	0.700	138	173	73	63	38
160	110	753 901 834	95.00	1.641	196	226	91	70	65

A

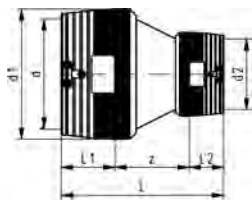

Reducer

- PE 100 SDR 11
- 4mm pin connectors
- Limited path fusion indicators
- Two separate fusion zones

d (mm)	d2 (mm)	Part No.	USD	weight (kg)	d1 (mm)	L (mm)	L1 (mm)	L2 (mm)	z (mm)
225	160	753 901 838	623.10	6.000	280	385	112	90	183
250	160	753 901 840	753.50	7.860	310	400	123	90	187

A

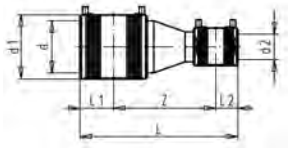

Reducer (kit)

- PE 100 SDR 11
- Integral pipe fixation (up to d63)
- 4mm pin connectors
- Limited path fusion indicators
- Supplied as kit including ELGEF® Plus Coupler and Spigot Reducer

d (mm)	d2 (mm)	Part No.	USD	weight (kg)	d1 (mm)	L (mm)	L1 (mm)	L2 (mm)	z (mm)
75	40	193 280 992	50.50	0.574	96	265	55	40	170
75	50	193 280 993	56.00	0.623	96	269	55	44	170
75	63	193 280 994	56.70	0.700	96	273	55	48	170
90	50	193 280 958	70.50	0.857	113	297	63	44	190
90	75	193 280 995	401.70	1.071	113	308	63	55	190
110	63	193 280 950	86.00	1.389	138	326	73	48	205
110	75	193 280 996	92.40	1.496	138	333	73	55	205
160	90	193 280 954	174.10	3.060	196	370	90	63	217

A

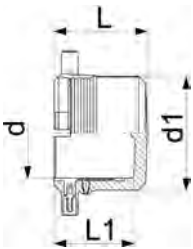

End cap With integral pipe fixation

- PE 100 SDR 11
- 4mm pin connectors
- Limited path fusion indicators

d (mm)	Part No.	USD	weight (kg)	d1 (mm)	L (mm)	L1 (mm)
20	753 961 606	13.40	0.041	35	52	44
25	753 961 607	14.30	0.046	35	52	44
32	753 961 608	16.40	0.058	44	52	44
40	753 961 609	18.10	0.064	54	56	47
50	753 961 610	26.70	0.154	66	60	49
63	753 961 611	30.00	0.142	81	66	54

A

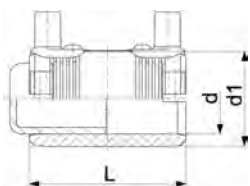

End cap (kit)

- PE 100 SDR 11
- 4mm pin connectors
- Limited path fusion indicators
- Supplied as kit including ELGEF® Plus Coupler

d (mm)	Part No.	USD	weight (kg)	d1 (mm)	L (mm)
75	753 961 712	47.90	0.446	96	110
90	753 961 713	62.80	0.663	113	125
110	753 961 714	80.50	1.090	133	145

A

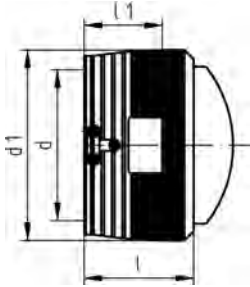

End cap

- PE 100 SDR 11
- 4mm pin connectors
- Limited path fusion indicators

d (mm)	Part No.	USD weight (kg)	d1 (mm)	L (mm)	L1 (mm)
160	753 961 617	139.60	200	143	90
225	753 961 620	411.50	280	170	112
250	753 961 621	539.00	310	185	123

A

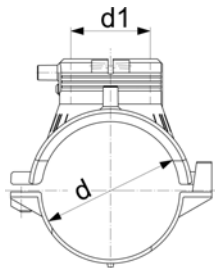

L = length / Länge

Electrofusion saddle

- PE 100 SDR 11
- Complete with lower part
- 4mm pin connectors
- Limited path fusion indicators

d (mm)	d1 (mm)	Part No.	USD weight (kg)	L (mm)
63	63	193 131 037	31.40	165
75	63	193 131 047	35.90	165
90	63	193 131 057	36.00	165
*	110	193 133 067	42.40	182
*	160	193 133 097	83.40	182
	225	193 131 127	118.70	165
	250	193 131 137	177.40	165

A

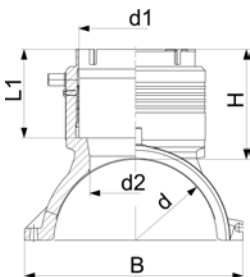

Branch saddle outlet 90 - 110mm

- PE 100 SDR 11
- 4mm pin connectors
- Limited path fusion indicators

d (mm)	d1 (mm)	Part No.	USD	GP weight (kg)	H (mm)	L (mm)	L1 (mm)	B (mm)	d2 (mm)	SDR pipe	
110	90	193 135 009	242.00	4	1.124	101	220	82	164	65	9-17.6
110	110	193 135 010	252.70	4	1.224	107	220	88	164	65	9-17.6
160	90	193 135 039	330.50	4	1.449	102	240	82	215	65	9-17.6
160	110	193 135 040	341.60	4	1.582	108	240	88	215	86	9-17.6
225	90	193 135 069	370.70	1	2.006	102	260	82	287	65	9-17.6
225	110	193 135 070	385.30	1	2.400	108	260	88	287	86	9-17.6
250	90	193 135 079	394.20	2	2.145	102	260	82	312	65	9-17.6
250	110	193 135 080	407.60	2	2.258	108	260	88	312	86	9-17.6

A



Tapping saddle (kit) With 360° rotatable outlet

- With integrated cutter to tap live mains under pressure
- Complete with lower part
- Limited path fusion indicators
- Long fusion outlet
- O-ring-sealed screw cap

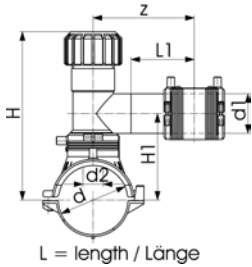
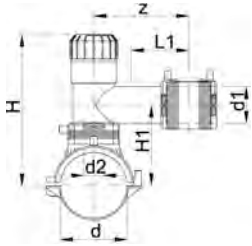

d (mm)	d1 (mm)	Part No.	USD	SP	weight (kg)	d2 (mm)	H (mm)	H1 (mm)	L (mm)	L1 (mm)	z (mm)
63	20	193 132 402	68.80	1	0.754	32	186	108	165	76	130
63	25	193 132 403	69.80	1	0.761	32	186	108	165	76	130
63	32	193 132 404	70.40	1	0.773	32	186	108	165	76	130
63	40	193 132 405	76.50	1	0.798	32	186	108	165	76	130
63	50	193 132 436	91.20	1	1.619	32	234	112	165	100	160
63	63	193 132 437	82.10	1	1.623	32	234	112	165	100	160
75	20	193 132 442	73.60	1	0.879	32	191	113	165	76	130
75	25	193 132 443	74.60	1	0.900	32	191	113	165	76	130
75	32	193 132 444	75.20	1	0.917	32	191	113	165	76	130
75	40	193 132 445	81.30	1	0.958	32	240	118	165	76	160
75	50	193 132 446	96.10	1	1.748	32	240	118	165	100	160
75	63	193 132 447	86.90	1	1.753	32	240	118	165	100	160
90	20	193 132 452	73.80	1	0.856	32	199	121	165	76	130
90	25	193 132 453	74.80	1	0.858	32	199	121	165	76	130
90	32	193 132 454	75.40	1	0.857	32	199	121	165	76	130
90	40	193 132 455	81.50	1	0.780	32	199	126	165	76	130
90	50	193 132 456	96.20	1	1.711	32	248	126	165	100	160
90	63	193 132 457	87.10	1	1.707	32	248	126	165	100	160
110	20	193 132 462	80.60	1	0.907	32	209	131	165	76	130
110	25	193 132 463	81.50	1	0.905	32	209	131	165	76	130
110	32	193 132 464	82.10	1	0.875	32	209	131	165	76	130
110	40	193 132 465	88.20	1	0.961	32	209	136	165	76	130
110	50	193 132 466	103.00	1	1.133	35	258	136	165	100	160
110	63	193 132 467	93.80	1	1.330	35	258	136	165	100	160
160	20	193 132 492	123.50	1	0.910	32	234	156	165	76	130
160	25	193 132 493	124.50	1	0.933	32	234	156	165	76	130
160	32	193 132 494	125.10	1	0.954	32	234	156	165	76	130
160	40	193 132 495	131.20	1	0.965	32	234	161	165	76	130
160	50	193 132 496	145.90	1	1.375	35	283	161	165	100	160
160	63	193 132 497	136.80	1	1.378	35	283	161	165	100	160
225	20	193 132 522	160.70	1	1.460	32	266	188	165	71	130
225	25	193 132 523	161.70	1	0.991	32	266	188	165	71	130
225	32	193 132 524	162.30	1	1.095	32	266	188	165	76	130
225	40	193 132 525	168.40	1	1.134	32	266	193	165	76	130
225	50	193 132 526	183.10	1	1.921	35	315	193	165	100	160
225	63	193 132 527	174.00	1	1.951	35	315	193	165	100	160

A

Transition Adaptor PE/SS Male thread NPT

- PE 100 SDR 11
- Only for ELGEF Plus Couplers and Fittings

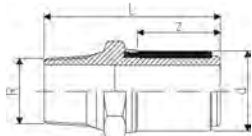

d (mm)	NPT (inch)	Part No.	USD	weight (lb)	z (mm)	L (mm)
20	¾	153 924 706	38.10	0.002	33	75
25	1	153 924 707	48.80	0.002	33	76
32	1 ¼	153 924 708	58.70	0.002	35	80
40	1 ½	153 924 709	74.50	0.002	39	86
50	2	153 924 710	77.20	0.002	43	90
63	2 ½	153 924 711	94.80	0.002	47	98

Pricing effective January 1, 2017

A



**Transition Adaptor PE/SS
Female thread NPT**

- PE 100 SDR 11
- Only for ELGEF Plus Couplers and Fittings

d (mm)	NPT (inch)	Part No.	USD weight (lb)	z (mm)	L (mm)
20	¾	153 924 206	29.60	0.002	33 65
25	¾	153 924 207	34.20	0.002	33 66
32	1	153 924 208	39.90	0.002	35 71
40	1 ¼	153 924 209	47.80	0.002	39 77
50	1 ½	153 924 210	56.60	0.002	43 81
63	2	153 924 211	87.00	0.002	47 89

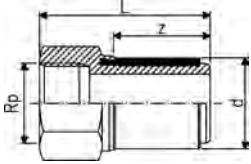

ecoFIT Long Spigot

A

Elbow 90° PE100 SDR11

- Long spigot version

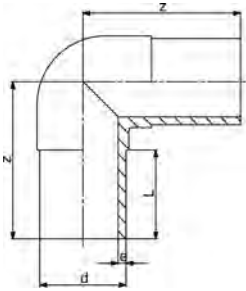

d (mm)	Part No.	USD	weight (kg)	PSI	z (mm)	L (mm)	e (mm)
20	753 101 006	4.70	0.027	200	75	52	3.0
25	753 101 007	4.80	0.040	200	80	52	3.0
32	753 101 008	5.30	0.056	200	85	54	3.0
40	753 101 009	6.70	0.089	200	95	57	3.7
50	753 101 010	8.80	0.156	200	105	63	4.6
63	753 101 011	16.10	0.274	200	115	65	5.8
75	753 101 012	21.10	0.414	200	130	72	6.8

A

Elbow 90° PE100 SDR17/17,6

- Long spigot version

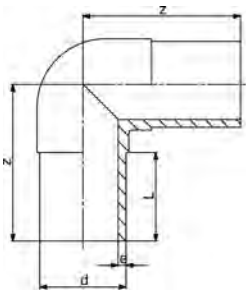

d (mm)	Part No.	USD	weight (kg)	z (mm)	L (mm)	e (mm)	PSI
90	753 100 813	21.60	0.543	150	81	5.4	130
110	753 100 814	40.40	0.876	165	86	6.6	130
160	753 100 817	75.00	2.385	210	102	9.5	130
225	753 100 820	138.70	5.864	270	120	13.4	130
250	753 100 821	268.40	8.000	292	130	14.8	130

A

Elbow 45° PE100 SDR11

- Long spigot version

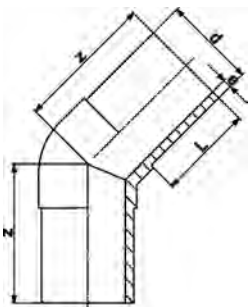

d (mm)	Part No.	USD	weight (kg)	z (mm)	L (mm)	e (mm)
20	753 151 006	4.20	0.027	70	52	3.0
25	753 151 007	4.30	0.037	75	52	3.0
32	753 151 008	6.30	0.050	80	54	3.0
40	753 151 009	7.80	0.086	85	57	3.7
50	753 151 010	9.00	0.133	90	63	4.6
63	753 151 011	16.10	0.227	95	65	5.8
75	753 151 012	21.60	0.350	105	72	6.8

A

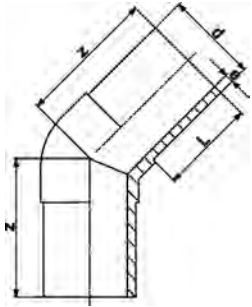

Elbow 45° PE100 SDR17/17,6

- Long spigot version

d (mm)	Part No.	USD weight (kg)	z (mm)	L (mm)	e (mm)	PSI	
90	753 150 813	21.60	0.411	120	81	5.4	130
110	753 150 814	35.30	0.686	130	86	6.6	130
160	753 150 817	75.00	1.901	162	102	9.5	130
225	753 150 820	138.70	4.441	205	123	13.4	130
250	753 150 821	269.90	6.012	217	130	14.8	130

A

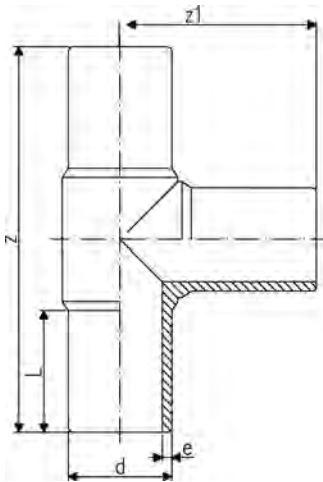

Tee 90° equal PE100 SDR11

- Long spigot version

d (mm)	Part No.	USD SP weight (kg)	z (mm)	z1 (mm)	L (mm)	e (mm)		
20	753 201 006	5.10	1	0.038	150	75	52	3.0
25	753 201 007	5.90	1	0.054	160	80	52	3.0
32	753 201 008	7.00	1	0.077	170	85	54	3.0
40	753 201 009	8.50	1	0.130	190	95	57	3.7
50	753 201 010	11.10	1	0.214	210	105	63	4.6
63	753 201 011	15.30	1	0.376	230	115	65	5.8
75	753 201 012	23.10	1	0.599	264	132	72	6.8

A

Tee 90° equal PE100 SDR17/17,6



- Long spigot version

d (mm)	Part No.	USD weight (kg)	z (mm)	z1 (mm)	L (mm)	e (mm)	DN (mm)
90	753 200 813	30.20	0.777	300	150	80	5.4
110	753 200 814	43.10	1.231	330	165	86	6.6
160	753 200 817	106.70	3.201	428	214	104	9.5
225	753 200 820	256.10	7.886	540	270	122	13.4
250	753 200 821	364.40	10.000	575	288	130	14.8

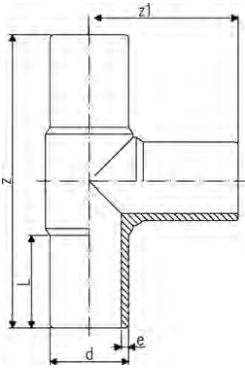

A

Tee 90° reduced PE100 SDR11



Model:

- Moulded
- 10 bar Gas / 16 bar Water
- Long spigot version

d (mm)	d1 (mm)	Part No.	USD weight (kg)	z (mm)	z1 (mm)	L (mm)	L1 (mm)	e (mm)	e1 (mm)	
63	40	753 201 026	34.70	0.312	230	107	60	58	2.0	1.75
63	50	753 201 044	34.70	0.305	216	103	60	56	5.8	4.6
75	32	753 201 045	53.80	0.519	258	106	70	46	6.8	2.9
75	50	753 201 046	53.80	0.531	257	110	70	56	6.8	4.6
75	63	753 201 047	53.80	0.554	252	117	70	63	6.8	5.8

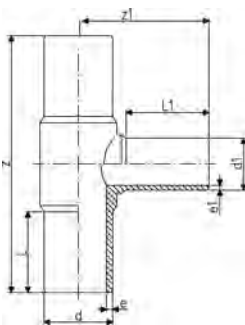

A

**Tee 90° reduced
PE100 SDR17/17.6**

- moulded
- Long spigot version

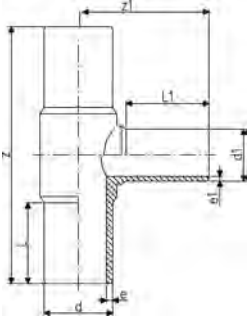

d (mm)	d1 (mm)	Part No.	USD	weight (kg)	z (mm)	z1 (mm)	L (mm)	L1 (mm)	e (mm)	e1 (mm)
110	90	753 200 832	130.10	0.941	318	158	82	79	6.6	5.4
160	90	753 200 836	288.30	1.972	410	188	98	79	9.5	5.4
160	110	753 200 837	290.10	2.716	410	195	98	82	9.5	6.6
225	90	753 200 840	650.40	4.732	555	226	127	80	13.4	5.4
225	110	753 200 841	654.60	4.700	555	235	127	82	13.4	6.6
225	160	753 200 842	656.20	5.922	555	253	127	98	13.4	9.5
250	110	753 201 878	892.00	9.400	575	242	130	82	14.8	6.6
250	160	753 201 879	909.50	9.800	575	261	130	98	14.8	9.5

A

Tee 45° equal PE100 SDR11

- Long spigot version
- See general information for maximum allowable operating pressure
- PE 100 SDR 11

Model:

- 10 bar Gas / 16 bar Water

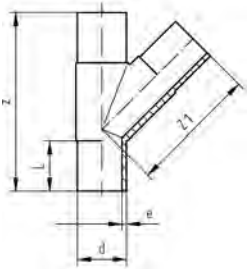

d (mm)	Part No.	USD	weight (kg)	z (mm)	z1 (mm)	L (mm)	e (mm)
50	753 251 010	Call	0.300	218	139	56	4.6
63	753 251 011	92.20	0.440	255	158	63	6.2
75	753 251 012	139.30	0.800	301	190	70	6.8

A

Tee 45° equal PE100 SDR17/17,6



- Long spigot version

d (mm)	Part No.	USD weight (kg)	z (mm)	z1 (mm)	L (mm)	e (mm)
90	753 251 063	208.00	0.800	368	234	79
110	753 251 064	295.40	1.400	395	260	82

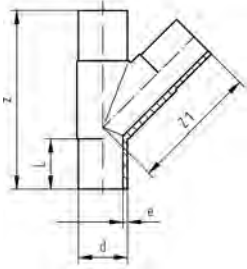

A

Branch 45° PE100 S8/SDR17.6

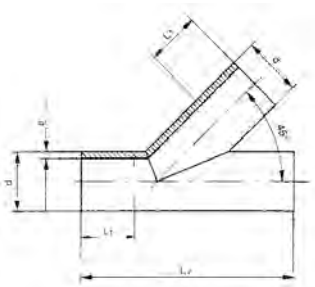

- For butt- and electro fusion
- Reduction factor = 0,5

d (mm)	Part No.	USD weight (kg)	L1 (mm)	L2 (mm)	e (mm)
110	700 649 286	Call	67.900	150	520
160	700 649 289	184.50	4.830	150	640
225	700 649 292	224.00	10.350	150	800
250	700 649 293	255.90	15.110	250	1000

A

Reducer PE100 SDR11



- Long spigot version

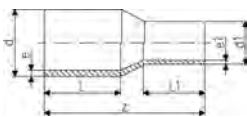

d (mm)	d1 (mm)	Part No.	USD weight (kg)	z (mm)	L (mm)	L1 (mm)	e (mm)	e1 (mm)
25	20	753 901 038	3.70	0.022	115	53	52	3.0
32	20	753 901 042	3.70	0.027	122	55	53	3.0
32	25	753 901 041	3.70	0.033	122	55	53	3.0
40	20	753 901 048	5.30	0.043	127	56	50	3.7
40	25	753 901 047	5.30	0.045	128	55	50	3.7
40	32	753 901 046	5.30	0.047	128	55	52	3.7
50	20	753 901 055	6.10	0.064	147	62	50	4.6
50	25	753 901 054	6.10	0.069	139	62	50	4.6
50	32	753 901 053	6.10	0.067	140	62	54	4.6
50	40	753 901 052	6.10	0.079	138	62	55	4.6
63	32	753 901 060	8.60	0.113	150	65	53	5.8
63	40	753 901 059	8.60	0.122	150	65	57	5.8
63	50	753 901 058	8.60	0.128	150	65	62	5.8
75	40	753 901 063	13.00	0.185	170	72	51	6.8
75	50	753 901 064	13.00	0.188	170	72	65	6.8
75	63	753 901 065	13.00	0.209	170	72	65	6.8

A

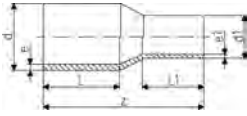
Reducer PE100 SDR17/17,6

- Long spigot version

d (mm)	d1 (mm)	Part No.	USD weight (kg)	z (mm)	L1 (mm)	L (mm)	e (mm)	e1 (mm)	
110	90	753 900 876	23.70	0.333	205	80	85	6.6	5,4
160	90	753 900 888	55.10	0.752	248	85	120	9.5	5,4
160	110	753 900 890	55.10	0.930	245	85	100	9.5	6,6
225	160	753 900 896	124.80	2.020	280	100	120	13.4	9,5
250	225	753 900 802	195.50	2.385	332	120	162	14.8	13,4

A

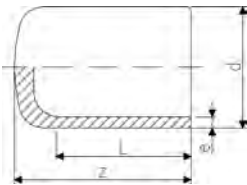
Cap PE100 SDR11

- Long spigot version

d (mm)	Part No.	USD weight (kg)	z (mm)	L (mm)	e (mm)	
20	753 961 006	4.00	0.010	52	52	3.0
25	753 961 007	4.30	0.015	52	52	3.0
32	753 961 008	5.50	0.020	54	54	3.0
40	753 961 009	6.70	0.033	57	57	3.7
50	753 961 010	8.60	0.054	63	63	4.6
63	753 961 011	11.40	0.086	65	65	5.8
75	753 961 012	21.10	0.146	80	72	6.8

A

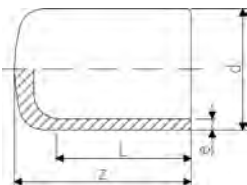
Cap PE100 SDR17/17,6

- Long spigot version

d (mm)	Part No.	USD weight (kg)	z (mm)	L (mm)	e (mm)	
90	753 960 813	25.70	0.214	90	81	5.4
110	753 960 814	32.70	0.272	98	86	6.6
160	753 960 817	49.30	0.920	120	102	9.5
225	753 960 820	101.00	2.265	148	122	13.4
250	753 960 821	137.00	2.547	205	130	14.8

A



Type A



Type B

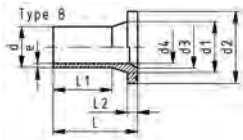
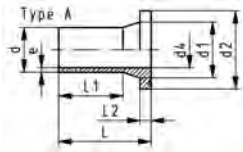

Flange Adapter SDR11

Model:

- Material: PE100
- Long spigot for Butt fusion or Electrofusion
- Suitable for flange connections to **ANSI/ASME B 16.5**
- Gasket: Profile flange gasket NBR No. 45 44 07, EPDM No. 48 44 07

d (mm)	FM	Part No.	USD	weight (kg)
20	IR	753 800 006	3.90	0.022
25	IR	753 800 057	4.10	0.031
32	IR	753 800 058	6.70	0.046
40	IR	753 800 059	5.60	0.070
50	IR	753 800 060	6.10	0.098
63	IR	753 800 011	7.30	0.187
75	IR	753 800 012	9.00	0.314

d (mm)	d1 (mm)	d2 (mm)	d3 (mm)	d4 (mm)	L (mm)	L1 (mm)	L2 (mm)	e (mm)	Type
20	27	45		16	85.0	41.0	7	1.9	A
25	33	54		20	90.5	62.0	9	2.3	A
32	40	63		26	91.5	61.0	10	3.0	A
40	50	73		32	94.5	61.5	11	3.7	A
50	61	82		40	105.0	55.0	12	4.6	A
63	75	102		51	98.0	69.0	14	5.8	A
75	89	122	66	61	125.0	89.0	16	6.8	B

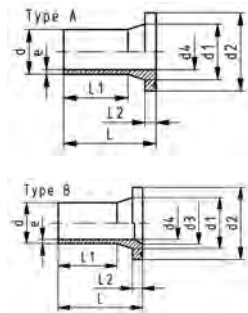
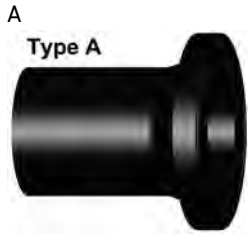

Flange Adaptor PE100 SDR17/17.6

Model:

- Material: PE100
- Long spigot for Butt fusion or Electrofusion
- Suitable for flange connections to metric (from d110 also to ANSI/ASME B16.5)
- Gasket d20-d630: Profile flange gasket NBR No. 45 44 07, EPDM No. 48 44 07
- Type A without chamfer, Type B with chamfer

d (mm)	DN (mm)	Part No.	USD	weight (kg)
90	80	753 800 088	11.80	0.367
110	100	753 800 089	14.80	0.571
160	150	753 800 092	26.60	1.342
225	200	753 800 095	50.80	2.456
250	250	753 800 096	85.10	3.500

d (mm)	d1 (mm)	d2 (mm)	d3 (mm)	d4 (mm)	L (mm)	L1 (mm)	L2 (mm)	e (mm)	Type
90	105	138		79	140	103	17	5.4	A
110	125	158		96	160	117	18	6.6	A
160	175	212	151	141	200	147	25	9.5	B
225	235	268	210	198	200	138	32	13.4	B
250	285	320	245	220	220	148	35	14.8	B

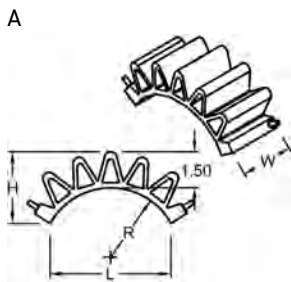

Electrofusion Flex Restraint, GF PE100

Range (mm)	Part No.	USD	weight (kg)	Axial Load (psi)	Pack Qty	W (inch)	H (inch)	L (inch)
160 - 250	*153 918 007	Call	0.190	9,000	5	3	3	5



Hose connector PE100 SDR11 metric

Model:

- Material: PE100
- With butt fusion spigot SDR11 and parallel hose connection

d (mm)	d1 (mm)	FM	Part No.	USD	weight (kg)	L (mm)	L1 (mm)	e (mm)
20	20	IR	753 968 606	24.60	0.007	64	27	1.9
25	25	IR	753 968 607	29.90	0.015	75	36	2.3
32	32	IR	753 968 608	38.50	0.023	82	36	2.9
40	40	IR	753 968 609	44.90	0.034	84	42	3.7
50	50	IR	753 968 610	86.50	0.057	90	48	4.6
63	60	IR	753 968 611	95.10	0.095	100	50	5.8

IPS to Metric Transitions

A



IPS to Metric Transition Reducer GF PE100 SDR 11

d2 (mm)	d (mm)	Part No. Part No.	USD weight (kg)	Pack Qty	L (inch)	
20	2	153 909 706	72.90	1	2	
25	2	153 909 707	72.90	1	2	
32	2	153 909 713	72.90	0.048	1	2
40	2	153 909 709	72.90		1	2
50	2	153 909 711	72.90	0.054	1	2

A

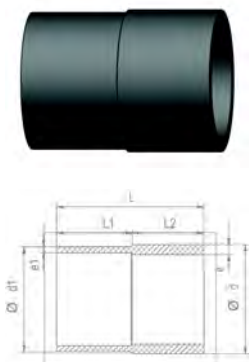

Transition Adapter IPS SDR11 x Metric SDR17 (63mm = SDR11)

D (inch)	d2 (mm)	L (mm)	L1 (mm)	L2 (mm)	e (inch)	e1 (mm)	PSI	Part No.	USD
2	63	113.0	60	53.0	0.216	5.8	200	153 909 211	72.90
3	90	141.5	74	67.5	0.318	5.1	200	153 909 313	90.60
4	110	156.5	81	75.5	0.409	6.3	200	153 909 414	81.60
6	160	204.0	109	95.0	0.602	9.1	200	153 909 617	131.60
8	225	241.5	124	117.5	0.784	12.8	200	153 909 820	1,036.40
10	250	261.0	132	129.0	0.977	14.2	200	153 909 921	799.50

A

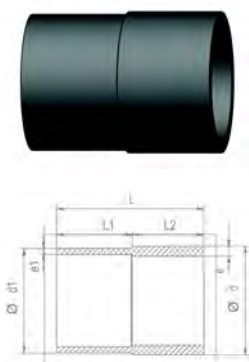

Transition Adapter IPS SDR17 x Metric SDR17 (63mm = SDR11)

D (inch)	d1 (mm)	L (mm)	L1 (mm)	L2 (mm)	e (inch)	e1 (mm)	PSI	Part No.	USD
2	63	113.0	60	53.0	0.140	5.8	130	153 911 211	58.60
3	90	141.5	74	67.5	0.206	5.1	130	153 911 313	90.60
4	110	156.5	81	75.5	0.265	6.3	130	153 911 414	81.60
6	160	204.0	109	95.0	0.390	9.1	130	153 911 617	131.60
8	225	241.5	124	117.5	0.507	12.8	130	153 911 820	1,036.40
10	250	261.0	132	129.0	0.632	14.2	130	153 911 921	799.50

A

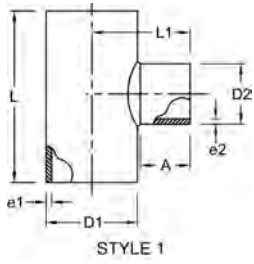

STYLE 1

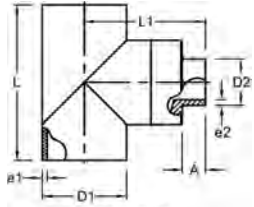

STYLE 2

Transition Reducing Tee IPS SDR17 x Metric SDR11

D1 (inch)	D2 (mm)	L (inch)	L1 (inch)	A (inch)	PSI	Part No.	USD
10	63	18	15	9	130	* 153 212 111	285.50
10	75	18	15	10	130	* 153 212 112	403.30
12	63	20	16	9	130	* 153 212 211	329.30
12	75	21	16	10	130	* 153 212 212	454.40
14	63	20	16	9	130	* 153 212 411	362.00
14	75	21	17	10	130	* 153 212 412	491.80
16	63	20	17	9	130	* 153 212 611	435.90
16	75	21	18	10	130	* 153 212 612	559.10
18	63	20	18	9	130	* 153 212 811	480.60
18	75	21	19	10	130	* 153 212 812	602.00
20	63	20	19	9	130	* 153 212 201	591.90
20	75	21	20	10	130	* 153 212 202	726.20
22	63	20	20	9	130	* 153 212 221	668.20
22	75	21	21	10	130	* 153 212 222	805.30
24	63	20	21	9	130	* 153 212 241	751.80
24	75	21	22	10	130	* 153 212 242	891.80

A

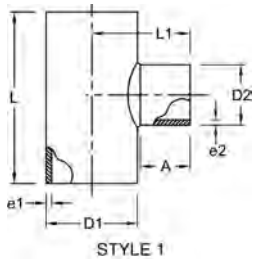

STYLE 1

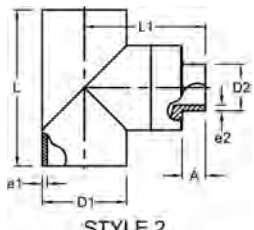

STYLE 2

Transition Reducing Tee IPS SDR11 x Metric SDR17

D1 (inch)	D2 (mm)	L (inch)	L1 (inch)	PSI	Part No.	USD
10	90	17.5	15.4	130	* 153 214 113	403.30
10	110	19.6	15.4	130	* 153 214 114	458.30
10	160	21.0	15.4	130	* 153 214 117	679.70
10	225	23.8	24.9	130	* 153 214 120	2,048.40
12	90	20.5	16.4	130	* 153 214 213	446.70
12	110	22.6	16.4	130	* 153 214 214	508.40
12	160	24.6	16.9	130	* 153 214 217	727.60
12	225	26.8	25.9	130	* 153 214 220	2,106.10
12	250	28.8	26.4	130	* 153 214 221	2,127.60
14	90	20.5	17.0	130	* 153 214 413	483.10
14	110	22.6	17.0	130	* 153 214 414	442.80
14	160	24.6	17.5	130	* 153 214 417	781.20
14	225	26.8	26.5	80	* 153 214 420	2,191.60
14	250	28.8	27.0	80	* 153 214 421	2,225.50
16	90	20.5	18.0	130	* 153 214 613	549.00
16	110	22.6	18.0	130	* 153 214 614	628.60
16	160	24.6	18.5	80	* 153 214 617	552.90
16	225	26.8	27.5	80	* 153 214 620	2,279.30
16	250	28.8	29.0	80	* 153 214 621	2,317.10

A

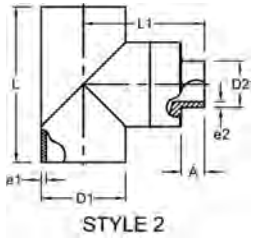
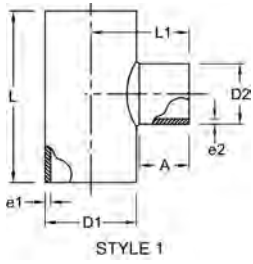

Transition Reducing Tee IPS SDR17 x Metric SDR17

D1	D2	L	L1	PSI	Part No.	USD
(inch)	(inch)	(inch)	(inch)			
10	90	17.5	15.4	130	* 153 216 113	296.70
10	110	19.6	15.4	130	* 153 216 114	458.30
10	160	21.0	15.4	130	* 153 216 117	679.70
10	225	23.8	24.9	130	* 153 216 120	2,048.40
12	90	20.5	16.4	130	* 153 216 213	446.70
12	110	22.6	16.4	130	* 153 216 214	517.70
12	160	24.6	16.9	130	* 153 216 217	900.60
12	225	26.8	25.9	130	* 153 216 220	2,297.10
12	250	28.8	26.4	130	* 153 216 221	2,335.90
14	90	20.5	17.0	130	* 153 216 413	491.80
14	110	22.6	17.0	130	* 153 216 414	560.90
14	160	24.6	17.5	130	* 153 216 417	795.50
14	225	26.8	26.5	80	* 153 216 420	2,213.80
14	250	28.8	27.0	80	* 153 216 421	2,457.40
16	90	20.5	18.0	130	* 153 216 613	559.10
16	110	22.6	18.0	130	* 153 216 614	640.70
16	160	24.6	18.5	130	* 153 216 617	885.70
16	225	26.8	27.5	80	* 153 216 620	2,303.60
16	250	28.8	28.0	80	* 153 216 621	2,348.70
18	90	20.5	19.0	130	* 153 216 813	602.00
18	110	22.6	19.0	130	* 153 216 814	688.10
18	160	24.6	19.5	130	* 153 216 817	933.50
18	225	26.8	28.5	80	* 153 216 820	2,350.00
18	250	28.8	29.0	80	* 153 216 821	2,392.20
20	90	19.5	19.4	130	* 153 216 913	726.20
20	110	22.6	20.0	130	* 153 216 914	806.70
20	160	24.6	20.5	130	* 153 216 917	1,057.10
20	225	26.8	29.5	80	* 153 216 920	2,480.90
20	250	28.8	30.0	80	* 153 216 921	2,723.80
22	90	20.5	21.0	130	* 153 216 943	805.30
22	110	22.6	21.0	130	* 153 216 944	891.30
22	160	24.6	21.5	130	* 153 216 947	1,147.10
22	225	26.8	30.5	80	* 153 216 950	2,579.10
22	250	28.8	31.0	80	* 153 216 951	3,704.40
24	90	20.5	22.0	130	* 153 216 963	891.80
24	110	22.6	22.0	130	* 153 216 964	983.80
24	160	24.6	22.5	130	* 153 216 967	1,245.50
24	225	26.8	31.5	80	* 153 216 970	2,686.50
24	250	28.8	32.0	80	* 153 216 971	3,841.70

A



**Electrofusion Type 329 Branch Saddle Valve
w/ PP Type 546 Ball Valve and PE Metric Spigot End SDR11**

d (mm)	PSI	SDR	EPDM Part No.	USD	FPM Part No.	USD
63 - 20	150	11/17	* 153 329 206	258.10	* 153 329 406	269.80
63 - 25	150	11/17	* 153 329 207	268.80	* 153 329 407	283.70
63 - 32	150	11/17	* 153 329 208	287.90	* 153 329 408	307.10
63 - 40	150	11/17	* 153 329 209	303.90	* 153 329 409	323.20
63 - 50	150	11/17	* 153 329 210	346.50	* 153 329 410	376.40
63 - 63	150	11/17	* 153 329 211	378.60	* 153 329 411	422.20
75 - 20	150	11/17	* 153 329 286	264.50	* 153 329 486	276.20
75 - 25	150	11/17	* 153 329 287	275.20	* 153 329 487	290.10
75 - 40	150	11/17	* 153 329 289	307.10	* 153 329 489	329.50
75 - 50	150	11/17	* 153 329 290	349.70	* 153 329 490	382.80
75 - 63	150	11/17	* 153 329 291	381.80	* 153 329 491	428.60
75 - 32	150	11/17	* 153 329 288	294.30	* 153 329 488	313.50
90 - 20	150	11/17	* 153 329 216	264.50	* 153 329 416	276.20
90 - 25	150	11/17	* 153 329 217	275.20	* 153 329 417	290.10
90 - 32	150	11/17	* 153 329 218	294.30	* 153 329 418	313.50
90 - 40	150	11/17	* 153 329 219	307.10	* 153 329 419	329.50
90 - 50	150	11/17	* 153 329 220	349.70	* 153 329 420	382.80
90 - 63	150	11/17	* 153 329 221	381.80	* 153 329 421	428.60
110 - 20	150	11/17	* 153 329 226	269.80	* 153 329 426	281.50
110 - 25	150	11/17	* 153 329 227	280.50	* 153 329 427	295.40
110 - 32	150	11/17	* 153 329 228	299.70	* 153 329 428	318.80
110 - 40	150	11/17	* 153 329 229	312.40	* 153 329 429	334.80
110 - 50	150	11/17	* 153 329 230	355.10	* 153 329 430	388.20
110 - 63	150	11/17	* 153 329 231	389.20	* 153 329 431	436.20
160 - 20	150	11/17	* 153 329 236	330.60	* 153 329 436	342.30
160 - 25	150	11/17	* 153 329 237	341.20	* 153 329 437	356.10
160 - 32	150	11/17	* 153 329 238	360.40	* 153 329 438	379.60
160 - 40	150	11/17	* 153 329 239	373.20	* 153 329 439	395.60
160 - 50	150	11/17	* 153 329 240	415.90	* 153 329 440	448.90
160 - 63	150	11/17	* 153 329 241	447.80	* 153 329 441	494.80
225 - 20	150	11/17	* 153 329 246	328.40	* 153 329 446	340.20
225 - 25	150	11/17	* 153 329 247	339.10	* 153 329 447	354.10
225 - 32	150	11/17	* 153 329 248	358.30	* 153 329 448	377.40
225 - 40	150	11/17	* 153 329 249	371.10	* 153 329 449	393.50
225 - 50	150	11/17	* 153 329 250	413.70	* 153 329 450	446.80
225 - 63	150	11/17	* 153 329 251	445.70	* 153 329 451	492.60
250 - 20	150	11/17	* 153 329 256	357.30	* 153 329 456	369.00
250 - 25	150	11/17	* 153 329 257	367.90	* 153 329 457	382.80
250 - 32	150	11/17	* 153 329 258	387.10	* 153 329 458	406.30
250 - 40	150	11/17	* 153 329 259	282.60	* 153 329 459	422.20
250 - 50	150	11/17	* 153 329 260	442.50	* 153 329 460	475.60
250 - 63	150	11/17	* 153 329 261	474.50	* 153 329 461	521.40

**Electrofusion Type 329 Branch Saddle Valve
w/ PVC Type 546 Ball Valve Inch Socket**



Size (inch) (inch)	PSI	SDR	EPDM Part No.	USD	FPM Part No.	USD
63 - ½	150	11/17	* 153 329 306	278.40	* 153 329 506	287.90
63 - ¾	150	11/17	* 153 329 307	289.00	* 153 329 507	298.50
63 - 1	150	11/17	* 153 329 308	290.10	* 153 329 508	317.80
63 - 1 ¼	150	11/17	* 153 329 309	312.40	* 153 329 509	328.40
63 - 1 ½	150	11/17	* 153 329 310	344.50	* 153 329 510	363.60
63 - 2	150	11/17	* 153 329 311	377.40	* 153 329 511	411.60
75 - ½	150	11/17	* 153 329 386	282.60	* 153 329 586	292.20
75 - ¾	150	11/17	* 153 329 387	293.30	* 153 329 587	302.90
75 - 1	150	11/17	* 153 329 388	294.30	* 153 329 588	322.00
75 - 1 ¼	150	11/17	* 153 329 389	316.70	* 153 329 589	332.70
75 - 1 ½	150	11/17	* 153 329 390	348.70	* 153 329 590	367.90
75 - 2	150	11/17	* 153 329 391	381.80	* 153 329 591	415.90
90 - ½	150	11/17	* 153 329 316	282.60	* 153 329 516	292.20
90 - ¾	150	11/17	* 153 329 317	293.30	* 153 329 517	302.90
90 - 1	150	11/17	* 153 329 318	294.30	* 153 329 518	322.00
90 - 1 ¼	150	11/17	* 153 329 319	316.70	* 153 329 519	332.70
90 - 1 ½	150	11/17	* 153 329 320	348.70	* 153 329 520	367.90
90 - 2	150	11/17	* 153 329 321	381.80	* 153 329 521	415.90
110 - ½	150	11/17	* 153 329 326	286.90	* 153 329 526	296.50
110 - ¾	150	11/17	* 153 329 327	297.50	* 153 329 527	307.10
110 - 1	150	11/17	* 153 329 328	298.50	* 153 329 528	326.40
110 - 1 ¼	150	11/17	* 153 329 329	321.00	* 153 329 529	337.00
110 - 1 ½	150	11/17	* 153 329 330	352.90	* 153 329 530	372.20
110 - 2	150	11/17	* 153 329 331	388.20	* 153 329 531	422.20
160 - ½	150	11/17	* 153 329 336	321.00	* 153 329 536	330.60
160 - ¾	150	11/17	* 153 329 337	331.60	* 153 329 537	341.20
160 - 1	150	11/17	* 153 329 338	332.70	* 153 329 538	360.40
160 - 1 ¼	150	11/17	* 153 329 339	355.10	* 153 329 539	371.10
160 - 1 ½	150	11/17	* 153 329 340	387.10	* 153 329 540	406.30
160 - 2	150	11/17	* 153 329 341	420.10	* 153 329 541	454.30
225 - ½	150	11/17	* 153 329 346	342.30	* 153 329 546	351.90
225 - ¾	150	11/17	* 153 329 347	352.90	* 153 329 547	362.50
225 - 1	150	11/17	* 153 329 348	354.10	* 153 329 548	381.80
225 - 1 ¼	150	11/17	* 153 329 349	376.40	* 153 329 549	392.40
225 - 1 ½	150	11/17	* 153 329 350	408.40	* 153 329 550	427.60
225 - 2	150	11/17	* 153 329 351	441.40	* 153 329 551	475.60
250 - ½	150	11/17	* 153 329 356	397.70	* 153 329 556	407.30
250 - ¾	150	11/17	* 153 329 357	408.40	* 153 329 557	418.00
250 - 1	150	11/17	* 153 329 358	409.50	* 153 329 558	437.20
250 - 1 ¼	150	11/17	* 153 329 359	314.60	* 153 329 559	447.80
250 - 1 ½	150	11/17	* 153 329 360	463.90	* 153 329 560	483.00
250 - 2	150	11/17	* 153 329 361	496.90	* 153 329 561	531.00

A



**Electrofusion Type 329 Branch Saddle Valve
w/ ABS Type 546 Ball Valve Metric Socket**

d (mm)	PSI	SDR	EPDM Part No.	USD
63 - 20	150	11/17	* 153 329 706	245.30
63 - 25	150	11/17	* 153 329 707	247.50
63 - 32	150	11/17	* 153 329 708	253.80
63 - 40	150	11/17	* 153 329 709	258.10
63 - 50	150	11/17	* 153 329 710	277.20
63 - 63	150	11/17	* 153 329 711	298.50
75 - 20	150	11/17	* 153 329 786	249.50
75 - 25	150	11/17	* 153 329 787	251.70
75 - 32	150	11/17	* 153 329 788	258.10
75 - 40	150	11/17	* 153 329 789	263.40
75 - 50	150	11/17	* 153 329 790	281.50
75 - 63	150	11/17	* 153 329 791	302.90
90 - 20	150	11/17	* 153 329 716	249.50
90 - 25	150	11/17	* 153 329 717	251.70
90 - 32	150	11/17	* 153 329 718	258.10
90 - 40	150	11/17	* 153 329 719	263.40
90 - 50	150	11/17	* 153 329 720	281.50
90 - 63	150	11/17	* 153 329 721	302.90
110 - 20	150	11/17	* 153 329 726	253.80
110 - 25	150	11/17	* 153 329 727	254.90
110 - 32	150	11/17	* 153 329 728	263.40
110 - 40	150	11/17	* 153 329 729	267.60
110 - 50	150	11/17	* 153 329 730	285.80
110 - 63	150	11/17	* 153 329 731	308.20
160 - 20	150	11/17	* 153 329 736	289.00
160 - 25	150	11/17	* 153 329 737	289.00
160 - 32	150	11/17	* 153 329 738	297.50
160 - 40	150	11/17	* 153 329 739	301.80
160 - 50	150	11/17	* 153 329 740	319.90
160 - 63	150	11/17	* 153 329 741	340.20
225 - 20	150	11/17	* 153 329 746	310.30
225 - 25	150	11/17	* 153 329 747	310.30
225 - 32	150	11/17	* 153 329 748	318.80
225 - 40	150	11/17	* 153 329 749	323.20
225 - 50	150	11/17	* 153 329 750	341.20
225 - 63	150	11/17	* 153 329 751	362.50
250 - 20	150	11/17	* 153 329 756	365.80
250 - 25	150	11/17	* 153 329 757	365.80
250 - 32	150	11/17	* 153 329 758	373.20
250 - 40	150	11/17	* 153 329 759	261.30
250 - 50	150	11/17	* 153 329 760	396.70
250 - 63	150	11/17	* 153 329 761	416.90

Valves

A



DN10/15 - 50

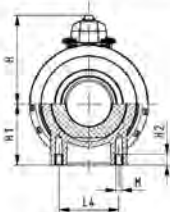
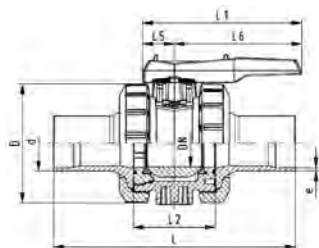
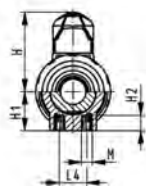
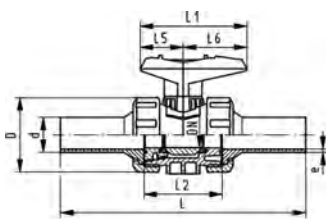

ecoFIT Ball Valve Type 546 PP-H with long spigot PE100 SDR11 ends for Butt fusion or Electrofusion

Model:

- Material: PP-H/PE
- Ball seals PTFE
- Integrated stainless steel mounting inserts
- Valve end and union nut are **not compatible** with Type 346 (DN10/15-50) and Type 370 (DN65-100)

Option:

- Pneumatic or electric actuators from GF

d (mm)	PN (bar)	EPDM Part No.	USD weight (lb)	FPM Part No.	USD
20	10	167 546 282	81.00	167 546 292	105.00
25	10	167 546 283	100.00	167 546 293	116.00
32	10	167 546 284	120.00	167 546 294	142.00
40	10	167 546 285	145.00	167 546 295	172.00
50	10	167 546 286	189.00	167 546 296	228.00
63	10	167 546 287	224.00	167 546 297	279.00
75	10	167 546 288	577.00	167 546 298	690.00

d (mm)	D (mm)	H (mm)	H1 (mm)	H2 (mm)	L (mm)	L1 (mm)	L2 (mm)	L4 (mm)	L5 (mm)	L6 (mm)	M	e (mm)	closest inch (inch)
20	50	57	27	12	193	77	56	25	32	45	M6	2.3	1/2
25	58	67	30	12	216	97	65	25	39	58	M6	2.3	3/4
32	68	73	36	12	223	97	71	25	39	58	M6	2.9	1
40	84	90	44	15	249	128	85	45	54	74	M8	3.7	1 1/4
50	97	97	51	15	271	128	89	45	54	74	M8	4.6	1 1/2
63	124	116	64	15	321	152	101	45	66	87	M8	5.8	2
75	166	149	85	15	386	270	136	70	64	206	M8	6.8	2 1/2

A

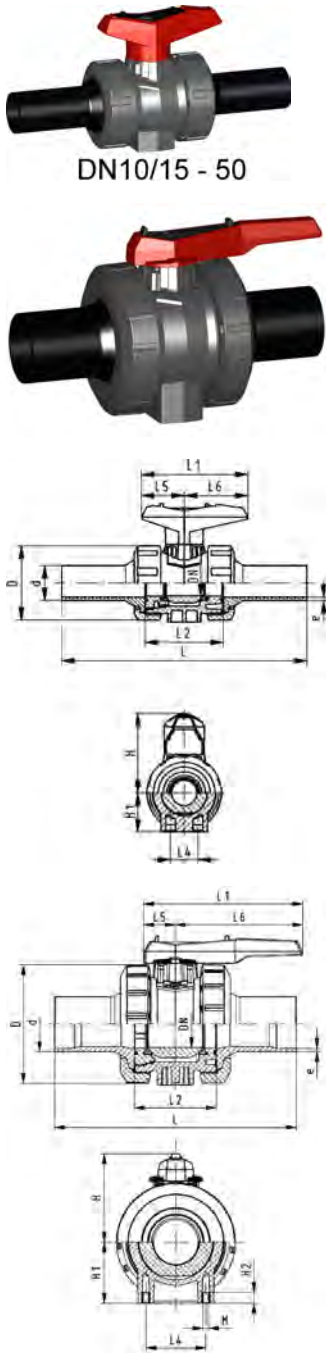

DN10/15 - 50

**ecoFIT Ball Valve Type 546 PVC
with long spigot PE100 SDR11 ends
for Butt fusion or Electrofusion**

Model:

- For easy installation and removal
- Ball seals PTFE
- Valve end and union nut are **not compatible** with Type 346 (DN10/15-50) and Type 370 (DN65-100)

Option:

- Individual configuration of the valve (see diagram)
- Multifunctional module with integrated limit switches
- Pneumatic or electric actuators from GF

d (mm)	PN (bar)	EPDM Part No.	USD	FPM Part No.	USD	weight (kg)
20	16	800 000 282	81.00	800 000 292	95.00	0.170
25	16	800 000 283	100.00	800 000 293	114.00	0.250
32	16	800 000 284	115.00	800 000 294	137.00	0.370
40	16	800 000 285	143.00	800 000 295	165.00	0.640
50	16	800 000 286	178.00	800 000 296	204.00	0.910
63	16	800 000 287	209.00	800 000 297	255.00	1.634

d (mm)	D (mm)	H (mm)	H1 (mm)	L (mm)	L1 (mm)	L2 (mm)	L4 (mm)	L5 (mm)	L6 (mm)	e (mm)	closest inch (inch)
20	50	57	27	193	77	56	25	32	45	2.2	1/2
25	58	67	30	216	97	65	25	39	58	2.3	3/4
32	68	73	36	223	97	71	25	39	58	3.0	1
40	84	90	44	249	128	85	45	54	74	3.7	1 1/4
50	97	97	51	271	128	89	45	54	74	4.6	1 1/2
63	124	116	64	321	152	101	45	66	87	5.8	2

A

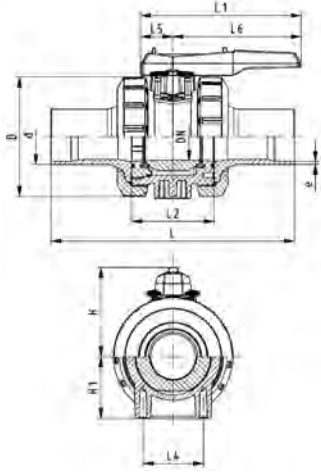

**ecoFIT Ball Valve Type 546 PVC
with long spigot PE100 SDR17.6 ends
for Butt fusion or Electrofusion**

Model:

- For easy installation and removal
- Ball seals PTFE
- Valve end and union nut are **not compatible** with Type 346 (DN10/15-50) and Type 370 (DN65-100)

Option:

- Individual configuration of the valve (see diagram)
- Multifunctional module with integrated limit switches
- Pneumatic or electric actuators from GF

d (mm)	PN (bar)	EPDM Part No.	USD	FPM Part No.	USD	weight (kg)
90	16	800 000 219	664.00	800 000 229	787.00	7.400
110	16	800 000 220	797.00	800 000 230	867.00	11.700

d (mm)	D (mm)	H (mm)	H1 (mm)	L (mm)	L1 (mm)	L2 (mm)	L4 (mm)	L5 (mm)	L6 (mm)	e (mm)	closest inch (inch)
90	200	161	105	421	270	141	70	64	206	5.1	3
110	238	178	123	484	320	164	120	64	256	6.3	4

A

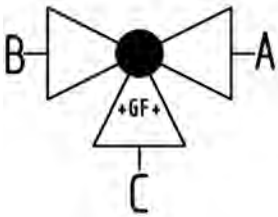
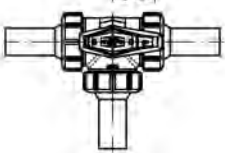
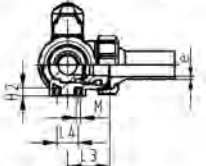
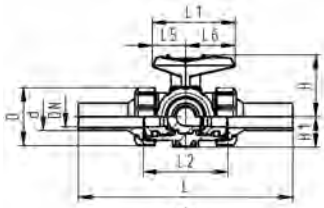

**ecoFIT Ball Valve Type 543 3-Way PP-H
with long spigot PE100 SDR11 metric ends
Horizontal/L-Port
for Butt fusion or Electrofusion**

Model:

- Material: PP-H/PE
- For easy installation and removal (valve end and union nut are compatible with type 546)
- Ball seals PTFE
- Pneumatic or electric actuator available separately
- Angle of operation 360° without turn limiter
- Turn limiter 90° enclosed, in different positions usable as a clip-on ring
- Integrated stainless steel mounting inserts
- Delivery status A-C opened, see flow scheme

d (mm)	PN (bar)	EPDM Part No.	USD	weight (kg)	FPM Part No.	USD
20	10	167 543 122	214.00	0.179	167 543 132	254.00
25	10	167 543 123	220.00	0.262	167 543 133	260.00
32	10	167 543 124	250.00	0.399	167 543 134	257.00
40	10	167 543 125	319.00	0.675	167 543 135	306.00
50	10	167 543 126	357.00	1.032	167 543 136	286.00
63	10	167 543 127	420.00	2.125	167 543 137	432.00

d (mm)	D (mm)	L (mm)	L1 (mm)	L2 (mm)	L3 (mm)	L4 (mm)	L5 (mm)	L6 (mm)	H (mm)	H1 (mm)	H2 (mm)	M (mm)	e (mm)	closest inch (inch)
20	50	210	77	72	36	25	32	45	57	28	8	6	2.3	1/2
25	58	237	97	85	43	25	39	58	67	32	8	6	2.3	3/4
32	68	250	97	98	49	25	39	58	73	36	8	6	2.9	1
40	84	282	128	118	59	45	54	74	90	45	9	8	3.7	1 1/4
50	97	317	128	135	68	45	54	74	97	51	9	8	4.6	1 1/2
63	124	396	152	176	88	45	66	87	116	65	9	8	5.8	2

A

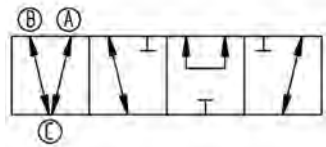
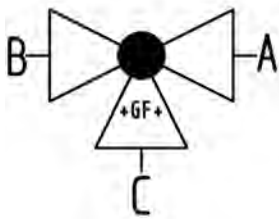
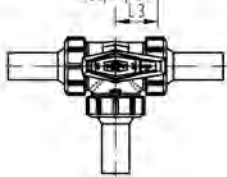
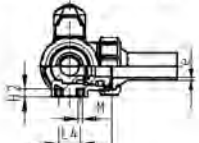
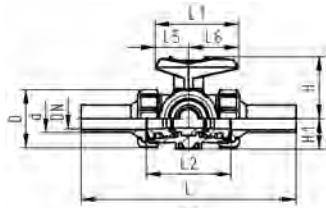

**ecoFIT Ball Valve Type 543 PP-H
with long spigot PE100 SDR11 ends
Horizontal/T-Port
for Butt fusion or Electrofusion**

Model:

- Material: PP-H/PE
- For easy installation and removal (valve end and union nut are compatible with type 546)
- Ball seals PTFE
- Pneumatic or electric actuator available separately
- Angle of operation 360° without turn limiter
- Turn limiter 90° enclosed, in different positions usable as a clip-on ring
- Integrated stainless steel mounting inserts
- Delivery status A-B-C opened, see flow scheme

d (mm)	PN (bar)	EPDM Part No.	USD	weight (kg)	FPM Part No.	USD
20	10	167 543 322	214.00	0.179	167 543 332	254.00
25	10	167 543 323	220.00	0.261	167 543 333	260.00
32	10	167 543 324	250.00	0.395	167 543 334	257.00
40	10	167 543 325	319.00	0.668	167 543 335	306.00
50	10	167 543 326	357.00	1.019	167 543 336	286.00
63	10	167 543 327	420.00	2.192	167 543 337	432.00

d (mm)	D (mm)	L (mm)	L1 (mm)	L2 (mm)	L3 (mm)	L4 (mm)	L5 (mm)	L6 (mm)	H (mm)	H1 (mm)	H2 (mm)	M (mm)	e (mm)	closest inch (inch)
20	50	210	77	72	36	25	32	45	57	28	8	6	2.3	1/2
25	58	237	97	85	43	25	39	58	67	32	8	6	2.3	3/4
32	68	250	97	98	49	25	39	58	73	36	8	6	2.9	1
40	84	282	128	118	59	45	54	74	90	45	9	8	3.7	1 1/4
50	97	317	128	135	68	45	54	74	97	51	9	8	4.6	1 1/2
63	124	396	152	176	88	45	66	87	116	65	9	8	5.8	2

A

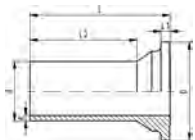

**ecoFIT Valve End Type 546 and 543
long spigot SDR11 metric**

Model:

- Material: PE100

d (mm)	PN (bar)	Part No.	USD	weight (kg)	D (mm)	e (mm)	L (mm)	L1 (mm)	L2 (mm)
20	16	193 480 152	9.00	0.013	38	2.2	69	4	53
25	16	193 480 153	12.00	0.023	44	2.3	76	5	58
32	16	193 480 154	12.90	0.032	53	2.9	76	5	58
40	16	193 480 155	16.60	0.054	65	3.7	82	5	61
50	16	193 480 156	17.60	0.086	77	4.6	91	6	63
63	16	193 480 157	19.70	0.165	99	5.8	110	7	77
75	16	193 480 158	64.90	0.280	125	6.8	125	9	89

A

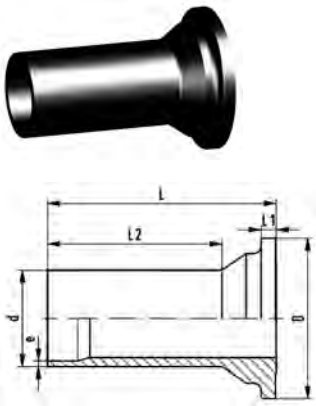

**ecoFIT Valve End Type 546 and 543
long spigot PE100 SDR17.6 metric**

Model:

- Material: PE100

d (mm)	PN (bar)	Part No.	USD	weight (kg)	D (mm)	e (mm)	L1 (mm)	L (mm)	L2 (mm)
75	16	193 480 168	Call	0.260	125	4.3	9	125	89
90	16	193 480 169	81.00	0.415	150	5.1	10	140	103
110	16	193 480 170	97.00	0.683	180	6.3	11	160	117

A

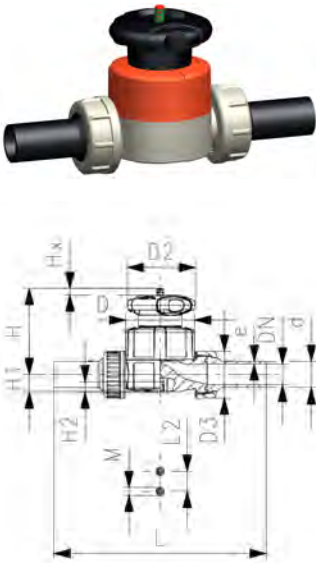

**ecoFIT Diaphragm Valve Type 514 PP-H with long spigot PE100 SDR11 metric True Union ends
for Butt fusion or Electrofusion**

Model:

- Material: PP-H/PE
- Double flow rate compared to predecessor
- One housing nut replaces four screws
- Handwheel with built-in locking mechanism
- For easy installation and removal
- Short overall length

Option:

- Individual configuration of the valve (see diagram)
- Self adjusting multifunctional module with integrated limit switches

d (mm)	PN (bar)	EPDM Part No.	USD	weight (kg)	PTFE/EPDM Part No.	USD
20	10	167 514 312	129.00	0.372	167 514 332	259.00
25	10	167 514 313	145.00	0.502	167 514 333	289.00
32	10	167 514 314	180.00	0.636	167 514 334	360.00
40	10	167 514 315	221.00	0.950	167 514 335	441.00
50	10	167 514 316	284.00	2.329	167 514 336	568.00
63	10	167 514 317	360.00	2.167	167 514 337	720.00

d (mm)	D (mm)	D2 (mm)	D3 (mm)	L (mm)	L2 (mm)	H (mm)	H1 (mm)	H2 (mm)	M	Lift = Hx (mm)	e (mm)	closest inch (inch)
20	65	65	48	196	25	73	14	12	M6	7	1.9	½
25	80	65	58	221	25	81	18	12	M6	10	2.3	¾
32	88	87	65	234	25	107	22	12	M6	13	2.9	1
40	101	87	79	260	45	115	26	15		15	3.7	1 ¼
50	117	135	91	284	45	148	32	15		19	4.6	1 ½
63	144	135	111	321	45	166	39	15		25	5.8	2

B



**Spare parts for valve body type 514
Valve end with spigot**

d (mm)	PE100 long Part No.	USD	SP	weight (kg)
20	753 508 616	Call	10	0.006
25	753 508 617	Call	10	0.019
32	753 508 618	Call	10	0.027
40	753 508 619	Call	10	0.048
50	753 508 620	Call	10	0.069
63	753 508 621	Call	10	0.120

A



ecoFIT Butterfly Valve Type 578 Lug Style PP-H with Hand Lever and ratchet settings

Model:

- Housing material: PP-GF30 with 316SS lug inserts
- Overall length according to EN 558, ISO 5752 (DN50 - 200 line 25, DN250 - 300 line 10)
- Connecting dimension: ANSI/ASME B 16.5 class 150, ASTM D 4024, BS 1560, BS EN 1759

Option:

- Optional accessory: Integrated position feedback with limit switches (sold separately)

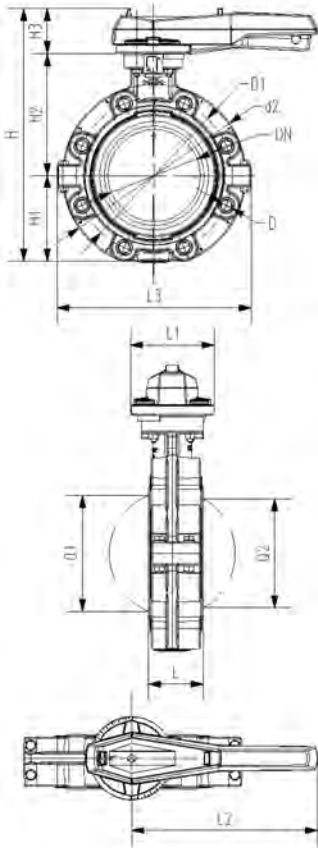

Size (inch)	PN (bar)	EPDM Part No.	USD	SP weight (kg)	FPM Part No.	USD	SP weight (kg)
2	10	167 578 102	979.00	1 1.800	167 578 122	1,044.00	1 1.800
2 ½	10	167 578 103	1,189.00	1 1.895	167 578 123	1,328.00	1 1.895
3	10	167 578 104	1,273.00	1 2.251	167 578 124	1,359.00	1 2.251
4	10	167 578 105	1,628.00	1 3.146	167 578 125	1,723.00	1 3.146
5	10	167 578 106	2,395.00	1 4.660	167 578 126	3,093.00	1 4.660
6	10	167 578 107	2,395.00	1 6.430	167 578 127	3,093.00	1 6.430
8	10	167 578 108	3,090.00	1 8.625	167 578 128	3,376.00	1 8.625
10	8	167 578 109	4,666.00	1 19.528	167 578 129	5,524.00	1 19.528
12	8	167 578 110	5,657.00	1 26.106	167 578 130	7,130.00	1 26.106

Size (inch)	d2 (mm)	D	D1 (mm)	H (mm)	H1 (mm)	H2 (mm)	H3 (mm)	L (mm)	L1 (mm)	L2 (mm)	L3 (mm)	Q1 (mm)	Q2 (mm)
2	160	UNC 5/8	120.6	265	77	134	54	45	106	205	165	40	
2 ½	180	UNC 5/8	139.7	277	83	140	54	46	106	205	182	54	35
3	195	UNC 5/8	152.4	289	89	146	54	49	106	205	210	67	50
4	226	UNC 5/8	190.5	326	106	167	55	56	106	255	240	88	74
5	258	UNC 3/4	215.9	357	121	181	55	64	106	255	272	113	97
6	284	UNC 3/4	241.3	377	133	189	55	72	106	255	300	139	123
8	341	UNC 3/4	298.4	436	159	210	67	73	140	408	360	178	169
10	412	UNC 7/8	362.0	536	205	264	67	113	140	408	440	210	207
12	482	UNC 7/8	431.8	586	234	285	67	113	140	408	510	256	253

A

**ecoFIT Butterfly Valve Type 578 Lug Style PP-H
with Gear Operator and Hand Wheel**

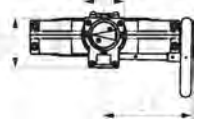
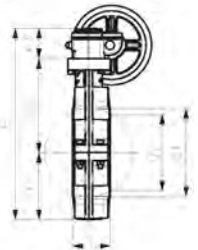
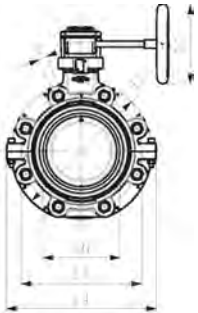

Model:

- Housing material: PP-GF30 with 316SS lug inserts
- Overall length according to EN 558, ISO 5752 (DN50 - 200 line 25, DN250 - 300 line 10)
- Connecting dimension: ANSI/ASME B 16.5 class 150, ASTM D 4024, BS 1560, BS EN 1759

Option:

- Optional accessory: Integrated position feedback with limit switches (sold separately)

Size (inch)	PN (bar)	EPDM Part No.	USD	SP	weight (kg)	FPM Part No.	USD	SP	weight (kg)
2	10	167 578 142	1,223.00	1	3.447	167 578 162	1,306.00	1	3.447
2 ½	10	167 578 143	1,399.00	1	3.585	167 578 163	1,561.00	1	3.585
3	10	167 578 144	1,498.00	1	3.929	167 578 164	1,598.00	1	3.929
4	10	167 578 145	1,810.00	1	4.834	167 578 165	1,915.00	1	4.834
5	10	167 578 146	2,520.00	1	6.348	167 578 166	3,256.00	1	6.348
6	10	167 578 147	2,520.00	1	8.109	167 578 167	3,256.00	1	8.109
8	10	167 578 148	3,254.00	1	9.353	167 578 168	3,555.00	1	9.353
10	8	167 578 149	4,911.00	1	21.210	167 578 169	5,924.00	1	21.210
12	8	167 578 150	5,953.00	1	27.746	167 578 170	7,505.00	1	27.746

Size (inch)	d2 (mm)	D	D1 (mm)	D3 (mm)	H (mm)	H1 (mm)	H2 (mm)	H3 (mm)	L (mm)	L1 (mm)	L2 (mm)	L3 (mm)	L4 (mm)	Q1 (mm)
2	160	UNC 5/8	120.6	160	273	77	134	62	45	78	112	179	165	40
2 ½	80	UNC 5/8	139.7	160	285	83	140	62	46	78	112	179	182	54
3	195	UNC 5/8	152.4	160	297	89	146	62	49	78	112	179	210	67
4	226	UNC 5/8	190.5	160	335	106	167	62	56	78	112	179	240	88
5	258	UNC 3/4	215.9	160	364	121	181	62	64	78	112	179	272	113
6	284	UNC 3/4	241.3	160	384	133	189	62	72	78	112	179	300	139
8	341	UNC 3/4	298.4	160	431	159	210	62	73	78	112	179	360	178
10	412	UNC 7/8	362.0	200	555	205	264	69	113	97	130	198	440	210
12	482	UNC 7/8	431.8	200	605	234	285	69	113	97	130	198	510	256

Size (inch)	Q2 (mm)
2	
2 ½	35
3	50
4	74
5	97
6	123
8	169
10	207
12	253

A



Type 567 Butterfly valve PROGEF Standard
Hand lever with ratchet settings

d	Size	EPDM	USD	FPM	USD
(mm)	(inch)	Part No.		Part No.	
63	2	167 567 002	312.00	167 567 022	392.00
75	2 ½	167 567 003	347.00	167 567 023	424.00
90	3	167 567 004	391.00	167 567 024	469.00
110	4	167 567 005	474.00	167 567 025	598.00
140	5	167 567 006	675.00	167 567 026	874.00
160	6	167 567 007	675.00	167 567 027	874.00
225	8	167 567 008	870.00	167 567 028	1,020.00
280	10	167 567 009	2,993.00	167 567 029	3,490.00
315	12	167 567 010	3,708.00	167 567 030	4,342.00

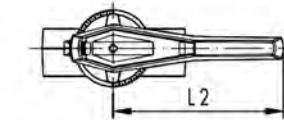
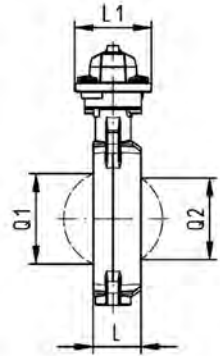
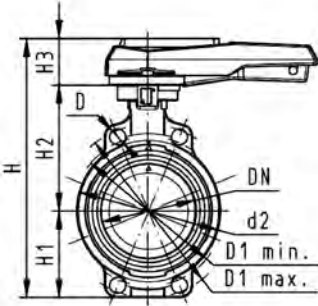

A

**Type 567 Butterfly valve PROGEF Standard
Reduction gear with handwheel**

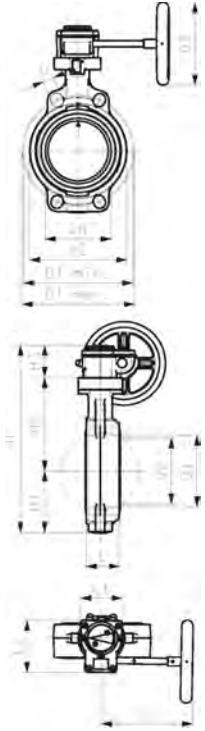

d (mm)	Size (inch)	EPDM Part No.	USD	FPM Part No.	USD	H (mm)
63	2	167 567 042	827.00	167 567 062	887.00	273
75	2 ½	167 567 043	872.00	167 567 063	923.00	285
90	3	167 567 044	913.00	167 567 064	997.00	297
110	4	167 567 045	997.00	167 567 065	1,088.00	333
140	5	167 567 046	1,077.00	167 567 066	1,340.00	360
160	6	167 567 047	1,077.00	167 567 067	1,340.00	381
225	8	167 567 048	1,239.00	167 567 068	1,553.00	430
280	10	167 567 049	3,284.00	167 567 069	3,793.00	555
315	12	167 567 050	3,997.00	167 567 070	4,633.00	599
355	14	* 167 567 051	7,695.00	167 567 071	8,535.00	
400	16	* 167 567 052	8,535.00	167 567 072	9,216.00	
450	18	* 167 567 053	12,168.00	* 167 567 073	13,439.00	
500	20	* 167 567 054	15,352.00	* 167 567 074	17,893.00	
630	24	* 167 567 055	20,078.00	* 167 567 075	22,730.00	