

BOSHART INDUSTRIES

Telephone: 1-519-595-4444 - Toll Free: 1-800-561-3164

Fax: 1-519-595-4380 - www.boshart.com

SECTION 7 RELIEF VALVES, FLOAT VALVES & ACCESS., AIR VOLUME CONTROLS, FLOW CONTROLS

PRODUCT LINE	PAGE
Relief Valves	1
No Lead Brass	
Stainless Steel	
PVC	
Snifter Valves	2
Bleeder Orifices	2
Float Valves	3
Plug Adapters	4
Float Rods	4
Floats	4
Stainless Steel	
Copper	
Plastic	
Black Economy Plastic	
Float Valve Parts	5
Air Volume Controls	6
Shallow Well	
Deep Well	
Brady Air Volume Controls	7
Brady A.V.C. Installation Kit	7
Flow Controls	8

BOSHART INDUSTRIES

Telephone: 1-519-595-4444 - Toll Free: 1-800-561-3164

Fax: 1-519-595-4380 - www.boshart.com

7-1

August 1/18

NO LEAD BRASS RELIEF VALVES (NON-ADJUSTABLE)

Pressure relief valves are recommended for all cold water system installations - to protect against damage to piping and pressure tanks. Set at 75 PSI or 100 PSI, (±) 15% setting accuracy, field adjustments are not recommended.

These valves are not T & P valves that are required with water heaters.

- Brass body
- Stainless steel spring and retaining screw
- Buna N sealing disc

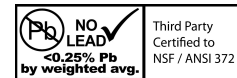

PART NO.	SIZE		FACTORY PRE-SET	QUANTITY		LIST PRICE-A
	IN	OUT		CTN	CASE	
RVNB05-075NL	1/2" MPT	1/2" FPT	75 PSI	10	100	12.67
RVNB07-075NL	3/4" MPT	1/2" FPT	75 PSI	10	100	13.64
RVNB05-100NL	1/2" MPT	1/2" FPT	100 PSI	10	100	12.67
RVNB07-100NL	3/4" MPT	1/2" FPT	100 PSI	10	100	13.64



Max. Operating Temp. 140°F (60°)

#304 STAINLESS STEEL RELIEF VALVES (NON-ADJUSTABLE)

Boshart recommends - Using both Gray Stainless Steel PTFE Tape & Gray Magic Pipe Thread Compound together for joining stainless steel threaded connections.

Pressure relief valves are recommended for all cold water system installations - to protect against damage to piping and pressure tanks. Set at 75 PSI, (±) 15% setting accuracy, field adjustments are not recommended.

PART NO.	SIZE		FACTORY PRE-SET	QUANTITY		LIST PRICE-A
	IN	OUT		CTN	CASE	
SSRVN05-075	1/2" MPT	1/2" FPT	75 PSI	10	100	20.42
SSRVN07-075	3/4" MPT	1/2" FPT	75 PSI	10	100	21.90
SSRVN05-100	1/2" MPT	1/2" FPT	100 PSI	10	100	20.42
SSRVN07-100	3/4" MPT	1/2" FPT	100 PSI	10	100	21.90



PVC RELIEF VALVES

Pressure relief valves are recommended for all cold water system installations - to protect against damage to piping and pressure tanks. Set at 75 PSI, (±) 15% setting accuracy, field adjustments are not recommended.

- PVC material
- Designed for low maintenance
- Factory Preset to 75 PSI (Adjustable to 150 PSI)
- High quality Stainless Steel spring

PART NO.	SIZE	FACTORY PRE-SET	QUANTITY		LIST PRICE-A
			CTN	CASE	
PVCRVN05-75150	1/2"	75 PSI	20	120	12.61



NO LEAD HEAVY DUTY RELIEF VALVES

Pressure relief valves are recommended for all cold water system installations - to protect against damage to piping and pressure tanks. Accuracy ± 15% of factory preset PSI. Field adjustments are not recommended.

These valves are not T & P valves that are required with water heaters.

- Heavy duty cast brass body
- Stainless steel spring

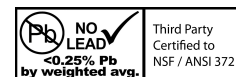

PART NO.	IN	SIZE		FACTORY PRE-SET	RANGE PSI		QTY	LIST PRICE-A
		OUT	MIN.		MAX.			
RVHD05NL	1/2" MPT	1/2" FPT	75 PSI	10	150	1	69.73	
RVHD07NL	3/4" MPT	3/4" FPT	75 PSI	10	100	1	85.20	
RVHD10NL	1" MPT	3/4" FPT	75 PSI	50	200	1	149.51	
RVHD12NL	1-1/4" MPT	1-1/4" FPT	65 PSI	50	200	1	253.54	
RVHD15NL	1-1/2" FPT	1-1/2" FPT	65 PSI	60	100	1	1030.76	
RVHD20NL	2" FPT	2" FPT	65 PSI	60	100	1	1053.38	

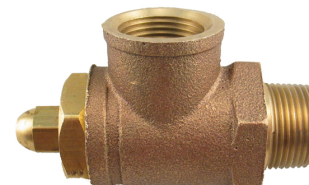

Max. Operating Temp. 140°F (60°)

NOTE: Valves will be sold at factory pre-set PSI only. While field adjustments are not recommended we have included the approximate range information shown above which has been provided by the manufacturer(s). However, **any changes made to the pre-set pressure is entirely at the risk of the person(s) / company who make the adjustment.** Any changes made should be thoroughly tested for accuracy at time of installation. **Neither the manufacturer or Boshart Industries Inc. will assume any liability or responsibility caused as a result of adjusting the relief valve setting. If the pressure setting is adjusted, it will void any warranty or return of the product.** Relief valves must be installed so that they drain to a floor drain, sump or other safe location with an air break. If an outlet pipe is used then it must be at least the same diameter as the relief valve outlet. **Cold water use only.**

BOSHART INDUSTRIES

7-2
September 25/17

Telephone: 1-519-595-4444 - Toll Free: 1-800-561-3164
Fax: 1-519-595-4380 - www.boshart.com

NO LEAD SNIFFER (AIR / TANK) VALVES

PART NO.	DESCRIPTION	WORKING PRESSURE	WORKING TEMP. (°F)	OPENING PRESSURE	QUANTITY		LIST PRICE-A
					BAG	CASE	
SV-0-NCS	1/8" MPT Snifter Valve Assembled with "Springless" valve core & vented cap *	15-150 PSI	-10° To +165°	3 PSI	10	100	5.41
SV-0NL	1/8" MPT Snifter Valve SV-0NL manufactured with light spring required for shallow well pump and bleeder systems	15-150 PSI	-10° To +165°	3 PSI	50	1000	3.59
SV-0-SC-VC	1/8" MPT Snifter Valve Assembled with light (soft core) spring & vented cap	15-150 PSI	-10° To +165°	3 PSI	10	100	4.95
SV-1-NCS	1/4" MPT Tank Valve Assembled with "Springless" valve core & vented cap *	15-150 PSI	-10° To +165°	3 PSI	10	100	6.45
SV-1NL	1/4" MPT Tank Valve General Purpose Peak of 300	0-200 PSI	-40° To +225°	60 PSI	50	800	4.32
SV-1-SC-VC	1/4" MPT Snifter Valve Assembled with light (soft core) spring & vented cap	15-150 PSI	-10° To +165°	3 PSI	10	100	5.89
SV-CAP-M	Chrome plated steel cap c/w rubber seal & valve core driver feature				10	100	1.32/cap
SV-CAP	Black Flexible Plastic Cap - has no sealing unit				10	100	0.40/cap



Valves must be ordered in multiples of 10.



* Vented Cap similar to SV-CAP-M but without rubber seal - allows air to vent through open orifice

BLEEDER ORIFICES

- BOB07NL - 3/4" MPT No Lead Brass
- Will not corrode or stick
- Rapid opening and closing valve for submersible pumps
- Complete closure prevents loss of pumping volume

- BOR10 - 1" MPT rubber
- Non-corrosive bleeder
- Fast bleed through its large opening



PART NO.	QUANTITY		LIST PRICE-A
	CTN	CASE	
BOB07NL	48	384	10.73



PART NO.	QUANTITY		LIST PRICE-A
	CTN	CASE	
BOR10	50	600	2.78



BOSHART INDUSTRIES

Telephone: 1-519-595-4444 - Toll Free: 1-800-561-3164

Fax: 1-519-595-4380 - www.boshart.com

7-3

August 1/18

NO LEAD BRASS BULKHEAD FLOAT VALVES - THREADED OUTLET

- Heavy duty body c/w Buna-N disc
- Rubber bulkhead gasket/brass nut
- Maximum operating temperature rating 180°F (82°C)
- Maximum operating pressure rating 125 PSI

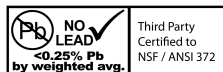

PART NO.	DESCRIPTION	INLET	OUTLET	ROD CONN. TAPPED	QUANTITY CTN	QUANTITY CASE	LIST PRICE-A
28-BHFV-05NL	1/2" SMT x 3/8" FPT	1/2" MPT	1/2" MPT	1/4" - 20 SAE	10	100	28.05
28-BHFV-07NL	3/4" SMT x 1/2" FPT	3/4" MPT	3/4" MPT	1/4" - 20 SAE	10	80	31.79

SMT = Straight Male Thread

NO LEAD BRASS FLOAT VALVES - THREADED OUTLET

- Heavy duty body c/w Buna-N disc
- Maximum operating temperature rating 180°F (82°C)
- Maximum operating pressure rating 125 PSI



PART NO.	SIZE	INLET	OUTLET	ROD CONN. TAPPED	QUANTITY CTN	QUANTITY CASE	SHIPPING WGT LBS	LIST PRICE-A
28-BFV-03NL	3/8"	3/8" MPT	3/8" MPT	1/4" - 20 SAE	10	100	0.66	22.67
28-BFV-05NL	1/2"	1/2" MPT	1/2" MPT	1/4" - 20 SAE	10	100	0.74	22.03
28-BFV-07NL	3/4"	3/4" MPT	3/4" MPT	1/4" - 20 SAE	10	80	0.96	25.28
28-BFV-10NL	1"	1" MPT	1" MPT	1/4" - 20 SAE	10	40	1.38	39.44

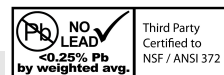

NO LEAD BRASS FLOAT VALVES - FAUCET OUTLET

- Heavy duty body c/w Buna-N disc
- Maximum operating temperature rating 180°F (82°C)
- Maximum operating pressure rating 125 PSI

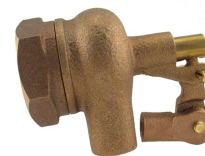
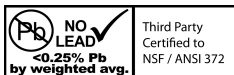

PART NO.	SIZE	INLET	OUTLET	ROD CONN. TAPPED	QUANTITY CTN	QUANTITY CASE	SHIPPING WGT LBS	LIST PRICE-A
28-BFV-12NL	1-1/4"	1-1/4" FPT	Faucet	3/8" - 16 SAE	1	20	3.10	101.18
28-BFV-15NL	1-1/2"	1-1/2" FPT	Faucet	3/8" - 16 SAE	1	20	3.24	96.72
28-BFV-20NL	2"	2" FPT	Faucet	3/8" - 16 SAE	1	20	3.44	108.07

NOTE: A 8" diameter float with a 12" rod is the minimum size recommended for use with 1 1/4" to 2" float valves.

PVC FLOAT VALVES

These heavy duty PVC Float Valves provide a low cost alternative for costly stainless steel or other metal float valves. They are ideal for automatic tank filling applications. The most common use of a float valve is to control the filling of livestock water tanks and water tower cooling tanks as well as many other automatic tank filling applications.

FEATURES:

- Heavy Duty PVC body will never corrode or rust.
- Corrosion resistant stainless steel bolt, wing nut and fulcrum pin.
- Replaceable seals are easily changed, and designed for long life.
 - Disc Seal: 1/2" thru 1" PVC Domed Cap Seal
 - 1-1/4" thru 1-1/2" NBR Domed Cap Seal
 - Piston Seal: 1/2" & 3/4" NBR O-Ring Seal
 - 1" thru 1-1/2" NBR Cup Seal
- Easy adjustable angle for liquid level control.
- Dual fulcrum pin holes allow for two positions to set the lever to accommodate different pressures and flow rates.
- Maximum operating pressure rating 100 psi.



PART NO.	SIZE	INLET	OUTLET	ROD CONN. TAPPED	PORT SIZE	QUANTITY CTN	QUANTITY CASE	LIST PRICE-A
28-PFV-05	1/2"	1/2" MPT	1/2" MPT	1/4" - SAE	0.50"	24	192	10.88
28-PFV-07	3/4"	3/4" MPT	3/4" MPT	1/4" - SAE	0.50"	12	144	12.30
28-PFV-10	1"	1" MPT	1" MPT	1/4" - SAE	0.75"	10	80	21.04
28-PFV-12	1-1/4"	1-1/4" MPT	1-1/4" MPT	3/8" - SAE	1.21"	1	28	67.04
28-PFV-15	1-1/2"	1-1/2" MPT	1-1/2" MPT	3/8" - SAE	1.21"	1	40	59.90

A complete line of plastic, copper and stainless steel floats and brass and stainless steel float rods are available in a wide range of sizes to accommodate all of your installation needs (sold separately).

BOSHART INDUSTRIES

7-4

Telephone: 1-519-595-4444 - Toll Free: 1-800-561-3164

August 1/18

Fax: 1-519-595-4380 - www.boshart.com

PLUG ADAPTERS

PART NO.	DESCRIPTION	LIST PRICE-A
28-BFVA-R434-0	1/4" - 20 SAE FEMALE X 3/8" MPT BRASS Adapts 1/4" rod (3/8" thru 1" valves) to 3/8" MPT (8" floats)	16.82
28-BFVA-R434-11	3/8" - 16 SAE FEMALE X 3/8" MPT BRASS Adapts 3/8" rod (1 1/4" thru 2" valves) to 3/8" MPT (8" floats)	17.11
28-BFVA-R435-5	3/8" - 16 SAE FEMALE X 1/4" - 20 SAE MALE Adapts 3/8" rod (1 1/4" thru 2" valves) to 1/4" rod (6" & smaller floats)	42.42



FLOAT RODS

PART NO.	LIST PRICE-A	THREAD SIZE	LENGTH	FITS VALVE
28-BFVRS-045	3.02	1/4 - 20 SAE x 1/4 - 20 SAE	4.5"	Use to connect 3/8" thru 1" float valves with float balls up to and including 6" diameter
28-BFVRS-06	3.50	1/4 - 20 SAE x 1/4 - 20 SAE	6"	
28-BFVRS-08	3.84	1/4 - 20 SAE x 1/4 - 20 SAE	8"	
28-BFVRS-10	4.29	1/4 - 20 SAE x 1/4 - 20 SAE	10"	
28-BFVRS-12	4.80	1/4 - 20 SAE x 1/4 - 20 SAE	12"	
28-BFVRS3814-10	12.85	3/8 - 16 SAE x 1/4 - 20 SAE	10"	Use to connect 3/8" thru 1" float valves with 8" or larger float balls. Or 1 1/4" thru 2" float valves with 6" or smaller float balls.
28-BFVRS3814-12	9.24	3/8 - 16 SAE x 1/4 - 20 SAE	12"	
28-BFVRS3814-14	9.74	3/8 - 16 SAE x 1/4 - 20 SAE	14"	
28-BFVRS3814-16	16.36	3/8 - 16 SAE x 1/4 - 20 SAE	16"	
28-BFVRS38-10	7.35	3/8 - 16 SAE x 3/8 - 16 SAE	10"	Use to connect 1 1/4" thru 2" float valves with 8" diameter and larger float balls.
28-BFVRS38-12	8.96	3/8 - 16 SAE x 3/8 - 16 SAE	12"	
28-BFVRS38-14	9.46	3/8 - 16 SAE x 3/8 - 16 SAE	14"	
28-BFVRS38-16	10.54	3/8 - 16 SAE x 3/8 - 16 SAE	16"	



Male SAE x Male SAE threads

STAINLESS STEEL FLOATS

- AISI 304 Stainless Steel
- Suitable for use in corrosive fluids where high pressure or extreme temperatures may exist

PART NO.	FLOAT DIAMETER	BUOYANCY IN LBS	FEMALE SPUD CONNECTION	WEIGHT LBS	LIST PRICE-A
28-BFVF-S3	3"	0.21	1/4 - 20 SAE	0.19	71.45
28-BFVF-S4	4"	0.65	1/4 - 20 SAE	0.44	112.28
28-BFVF-S5	5"	1.55	1/4 - 20 SAE	0.81	148.01
28-BFVF-S6	6"	2.15	1/4 - 20 SAE	1.19	224.57
28-BFVF-S8	8"	6.50	3/8 - 16 SAE	1.81	316.44



COPPER FLOATS

- Two float halves soldered together using an inside lapping joint
- For open tank service only

PART NO.	FLOAT DIAMETER	BUOYANCY IN LBS	FEMALE SPUD CONNECTION	WEIGHT LBS	LIST PRICE-A
28-BFVF-C3	3"	0.34	1/4 - 20 SAE	0.19	76.26
28-BFVF-C4	4"	0.80	1/4 - 20 SAE	0.38	58.05
28-BFVF-C5	5"	1.73	1/4 - 20 SAE	0.56	80.49
28-BFVF-C6	6"	3.26	1/4 - 20 SAE	0.69	101.47
28-BFVF-C8	8"	8.03	3/8" FPT	1.94	388.72



Note: It is not recommended to use less than an 8" diameter float with 1 1/4" to 2" valves. Due to a lack of buoyancy - 6" & smaller floats can be used where inlet pressure is very low.

BOSHART INDUSTRIES

Telephone: 1-519-595-4444 - Toll Free: 1-800-561-3164

Fax: 1-519-595-4380 - www.boshart.com

7-5

August 1/18

PLASTIC FLOATS

- Polypropylene
- Lightweight
- For open tank service only

- Corrosion resistant
- Up to 175°F (79°C)



PART NO.	FLOAT DIAMETER	BUOYANCY LBS / CU.FT	FEMALE SPUD CONNECTION	WEIGHT LBS	LIST PRICE-A
28-BFVF-P5 *	5"	1.2	1/4 - 20 SAE	0.18	10.02
28-BFVF-P6 *	6"	3.4	1/4 - 20 SAE	0.29	32.85
28-BFVF-P8 *	8"	8.4	1/4 - 20 SAE	1.00	47.48



* Float rod connection is not factory threaded, the smooth hole is designed for easy self-tapping by threading the metal float rod into the blind hole.

BLACK ECONOMY PLASTIC FLOATS

- Polyethylene
- Good impact resistance
- Excellent corrosive resistance

- Good abrasive resistance
- Up to 150°F (65°C)



PART NO.	DESCRIPTION	FEMALE SPUD CONNECTION	LIST PRICE-A
28-BFVF-PL4.5 *	4.5" Black Plastic Float	1/4" - 20 SAE Female	2.07
28-BFVF-PL5 *	5" Black Plastic Float	1/4" - 20 SAE Female	2.29
28-BFVF-PL6 *	6" Black Plastic Float	1/4" - 20 SAE Female	4.99
28-BFVF-PL8 ◇	8" Black Plastic Float	3/8" - 16 SAE Female	17.09
28-BFVF-PL10 ◇	10" Black Plastic Float	3/8" - 16 SAE Female	29.88



4.5" Black Plastic Float

NOTE: These units should not be used in applications that require them to be fully submersed. For those applications, use Series 28-BFVF-P.

* Float rod connection is not factory threaded, the smooth hole is designed for easy self-tapping by threading the metal float rod into the blind hole.

◇ Floats have a threaded brass insert rod connection

FLOAT VALVE PARTS

LEVER ASSEMBLY	
PART NO.	LIST PRICE-A
28-BFVP-LA0310 (For 3/8" - 1" Float Valve)	14.56

PLUNGER ASSEMBLY	
PART NO.	LIST PRICE-A
28-BFVP-PA0305 (For 3/8" - 1/2" Float Valve)	6.00

REPL. SEAL KIT	
PART NO.	LIST PRICE-A
28-BFVP-SK0305 (For 3/8" - 1/2" Float Valve)	0.61

28-BFVP-LA1220 (For 1 1/4" - 2" Float Valve)	14.74
---	-------

28-BFVP-PA10 (For 1" Float Valve)	12.53
28-BFVP-PA1220 (For 1 1/4" - 2" Float Valve)	24.08

28-BFVP-SK07 (For 3/4" Float Valve)	0.91
28-BFVP-SK10 (For 1" Float Valve)	0.70
28-BFVP-SK1220 (For 1 1/4" - 2" Float Valve)	1.18



3/8" To 1"



1 1/4" To 2"



3/8" & 1/2"



3/4" & 1"



1 1/4" To 2"

PLASTIC JET PUMP AIR CONTROL

- Air volume control for jet systems that cures waterlogged tanks
- Positive action control - Simple in construction
- No flexing diaphragm or metal springs
- Will operate on as little as 5" of vacuum
- Molded from space age technology plastics - cannot corrode in moist environment
- Fits all size tanks up to and including 82 gallon - may be easily manifolded for larger size tanks



PART NO.	DESCRIPTION	CASE QTY	LIST PRICE-A
AVC-P	Air Control	25	19.62
AVC-PK	Air Control Installation Package		13.24
	Contains:		
	• 4 ft. Poly Tubing		
	• (2) 1/4" MIP x 1/4" Barb Brass Adapters		
AVC-PKC	Air Control Package		26.73
	Contains:		
	• Air Control and Installation Package		



AVC-P

BOSHART INDUSTRIES

7-6
September 25/17

Telephone: 1-519-595-4444 - Toll Free: 1-800-561-3164
Fax: 1-519-595-4380 - www.boshart.com

AIR VOLUME CONTROLS

SHALLOW WELL CONTROL

- Comes complete with 48" of 1/4" poly tubing and brass mini barb adapters
- Housing is tapped with a 1/4" FPT pressure gauge port

PART NO.	MANUFACTURER	TANK CONN.	WEIGHT LBS	QUANTITY		LIST PRICE-A
				CTN	CASE	
AVC-SW	BOSHART INDUSTRIES	1-1/4" MPT	1.0	1	50	29.33
AVC-L	AMETEK	1-1/4" MPT	1.0	1	20	78.97

- Zinc die-cast housing with sealed plastic float mounted on solid brass rod

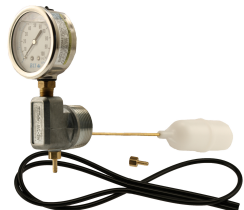

AVC-SW

NOTE: GAUGE IS SOLD SEPARATELY



AVC-L

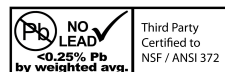

DEEP WELL AIR RELEASE

- Housing is tapped with a 1/4" FPT pressure gauge port

PART NO.	MANUFACTURER	TANK CONN.	WEIGHT LBS	QUANTITY		LIST PRICE-A
				CTN	CASE	
AVC-DWP	BOSHART INDUSTRIES	1-1/4" MPT	0.4	1	50	24.86
AVC-PENN-WJ	PENN	1-1/4" MPT	0.4	50		46.06

- Durable plastic housing with sealed plastic float, stainless steel rod and hardware

- Durable plastic housing with sealed plastic float and brass rod



AVC-DWP

NOTE: GAUGE IS SOLD SEPARATELY

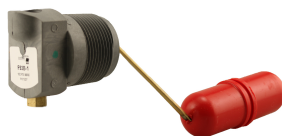

AVC-PENN-WJ

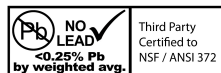

DEEP WELL WITH ADJUSTABLE MINIMUM AIR RELEASE

- Minimum pressure air release valve is factory set @ 25psi, Adjustable range is 0 - 40psi
- Housing is tapped with a 1/4" FPT pressure gauge port

PART NO.	MANUFACTURER	TANK CONN.	WEIGHT LBS	QUANTITY		LIST PRICE-A
				CTN	CASE	
AVC-DW-AR	BOSHART INDUSTRIES	1-1/4" MPT	1.0	1	50	34.28
AVC-WJ	AMETEK	1-1/4" MPT	1.0	20		78.89
AVC-AE10 *		1-1/4" MPT	1.0		50	34.11

- Zinc die-cast housing with sealed plastic float, stainless steel rod and hardware

- Zinc die-cast housing with sealed plastic float mounted and brass rod

- All plastic construction

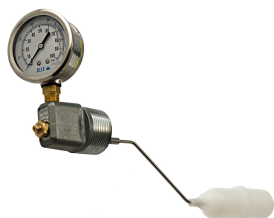

AVC-DW-AR

NOTE: GAUGE IS SOLD SEPARATELY



AVC-WJ



AVC-AE10*

* NOT 3RD PARTY CERTIFIED TO NSF/ANSI 372

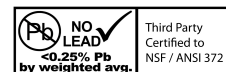

BOSHART INDUSTRIES

Telephone: 1-519-595-4444 - Toll Free: 1-800-561-3164

Fax: 1-519-595-4380 - www.boshart.com

7-7

December 4/15

USAGE RECOMMENDATIONS

PRESSURE SYSTEM RANGE

TANK SIZE	20-40 PSI	30-50 PSI	40-60 PSI
Thru 42 Gallons	AV30 / AVC45 / AV45	AV42 / AVC45 / AV45	AV42 / AVC45 / AV45
70 Gallons	AV42 / AVC100 / AV100	AV80 / AVC100 / AV100	AV80 / AVC100 / AV100
80 Gallons	AV100 / AVC100	AV100 / AVC100	AV100 / AVC100
120 Gallons	AV80 / AVC100	AV120	AV120
	AV100 / AVC100	AV100 / AVC100	AV100 / AVC100
220 Gallons	AV120	AV120	AV120

NON-REPAIRABLE AIR VOLUME CONTROL

- Ensure proper water pressure
- Maximum working pressure not to exceed 100 PSI
- Prolong pump life by reducing cycling frequency
- Zinc-electroplated steel construction

PART NO.	TANK CONNECTION	PUMP CONNECTION	QUANTITY	LIST PRICE-A
AVC45	1/4" NMPT	1/4" Male Compression Thread	1 20	11.47
AVC100	3/8" NMPT	1/4" Male Compression Thread	1 20	11.47



BRADY NON-REPAIRABLE AIR VOLUME CONTROLS

- Maximum working pressure not to exceed 100 PSI
- AV100 Incorporates a ball check valve so it can be universally used on tank sizes from 12 to 120 gallons and function properly with a minimum amount of vacuum or in areas where high water tables may be a problem
- AV45 Brass spring and orifice
- Zinc-electroplated steel construction

PART NO.	TANK CONNECTION	PUMP CONNECTION	CASE QTY	LIST PRICE-A
AV45	1/4" MPT	1/4" Male Compression Thread		59.85
AV45F	1/4" MPT	1/8" Female Pipe Thread	20	64.20
AV100	3/8" MPT	1/4" Male Compression Thread		61.95
AV100F	3/8" MPT	1/8" Female Pipe Thread	20	77.94

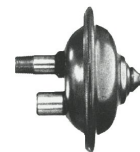

BRADY REPAIRABLE AIR VOLUME CONTROLS

- Maximum working pressure not to exceed 100 PSI
- Zinc-die cast construction
- Buna-N diaphragm
- Reduces cycling frequency
- Can be used on jet, centrifugal & rotary pumps

PART NO.	TANK CONNECTION	PUMP CONNECTION	CASE QTY	LIST PRICE-A
AV30	1/4" MPT	7/16" - 24 THD	42	78.47
AV42	1/4" FPT	1/4" FPT		107.42
AV80	1/4" FPT	1/4" FPT	18	104.21
AV120	1/4" FPT	1/4" FPT	14	137.29



AV30



AV42, 80 & 120 style

Note that Brady has discontinued drilling and tapping this gauge port

BRADY A.V.C. REPAIR KITS

Kit includes: diaphragm, springs, screws, nuts, ball and seal which are needed for a quick and simple repair job.

PART NO	LIST PRICE-A	PART NO	LIST PRICE-A
AV-30-3A	41.26	AV-80-3A	56.70
AV-42-3A	44.88	AV-120-3A	75.30

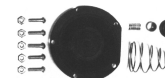

BRADY A.V.C. INSTALLATION KIT

• KIT INCLUDES:

- (2) Fitting No. 75-1/8 1/4" Barb x 1/8" MPT Plastic Fitting
- (2) Fitting No. 75-1/4 1/4" Barb x 1/4" MPT 90 Elbow Plastic Fitting
- (1) Fitting No. 78E 1/4" Barb x 7/16" Compression Elbow Plastic Fitting
- (1) 4' of Polyethylene Tubing 1/4" I.D. x 3/8" O.D.

- A fitting attaches to suction side of pump for air volume control use and to pressure side of pump for pressure switch use or the second fitting attaches to pump side of AV-42, AV-80 and AV-120 air volume controls for air volume control use. For pressure switch installation, it attaches to pressure switch and pressure side of pump.

PART NO.	QTY	LIST PRICE-A
AVC-UK1		34.38

BOSHART INDUSTRIES

7-8
December 4/15

Telephone: 1-519-595-4444 - Toll Free: 1-800-561-3164
Fax: 1-519-595-4380 - www.boshart.com

DOLE FLOW CONTROLS

- Self Cleaning
- Delivers a constant volume of water flow output over a wide pressure drop range
- Flexible orifice varies effective area inversely to the applied pressure
- At pressures below threshold point, flexible insert acts as a fixed orifice
- Above threshold point, insert begins to reduce orifice area maintaining desired flow output
- Flow rates maintained to within $\pm 15\%$ up to pressure drops of 125 psi
- Flow rate varies due to tolerances and water temperatures
- Used, where possible, in flow regulators with flow rates between 1 US GPM and 4 US GPM
- All flow regulators are recommended for potable water below 180°F

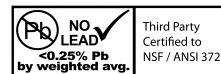

- Nickel Plated Brass Housing
- To order add Flow Rate to Part No. eg. FCGA-.35NL

PART NO.	CONNECTION	HEX SIZE	LENGTH	AVAILABLE FLOW RATES	LIST PRICE-A
FCGA-.... NL	3/8 X 3/8 FPT	7/8"	1 3/4"	.125, .1875, .25, .35, .5, .75, 1	33.97
FCGB-.... NL	1/2 X 1/2 FPT	1"	2"	1, 1.5, 2, 2.5, 3, 3.5, 4, 5, 6	39.49
FCGC-.... NL	3/4 X 3/4 FPT	1-1/4"	2-1/4"	1, 1.5, 2, 2.5, 3, 3.5, 4, 4.5, 5, 6, 7, 8, 9, 10, 11.5	52.26
FCGY-.... NL	3/4 M X 3/4 F	1-1/4"	1-1/2"	1, 1.5, 2, 2.5, 3, 3.5, 4, 5, 6, 7, 8, 9, 10	71.39
FCGX-.... NL	1 X 1 FPT	1-1/2"	2-3/4"	1, 1.5, 2, 2.5, 3, 3.5, 4, 4.5, 5, 5.5, 6, 7, 8, 9, 10, 12, 13.5, 15, 20, 25, 30	83.96

- Zinc Plated Steel Housing
- To order add Flow Rate to Part No. eg. FCGH-30NL

PART NO.	CONNECTION	HEX SIZE	LENGTH	AVAILABLE FLOW RATES	LIST PRICE-A
FCGP-.... NL	1-1/4 X 1-1/4 MPT	1-5/8"	3"	2, 2.5, 3, 4, 5, 7, 8, 9, 10, 12, 15, 20, 25, 30	151.97
FCGT-.... NL	1-1/2 X 1-1/2 MPT	1-13/16"	3"	1, 1.5, 2, 2.5, 3, 3.5, 4, 5, 6, 7, 8, 9, 10, 12, 13.5, 15, 20, 25, 30	168.33
FCGF-.... NL	2 X 2 MPT	2-3/8"	3"	10, 11.5, 12, 13.5, 15, 20, 25, 30	287.01
FCGH-.... NL	2-1/2 X 2-1/2 MPT	2-7/8"	4"	30, 35, 40, 45, 50, 55, 60, 65, 70, 75, 80, 85, 90	636.04
FCGK-.... NL	3 X 3 MPT	3-1/2"	4"	30, 35, 40, 45, 50, 55, 60, 65, 70, 75, 80, 85, 90, 95, 100, 105, 110, 115, 120	661.28

Flow Characteristics:

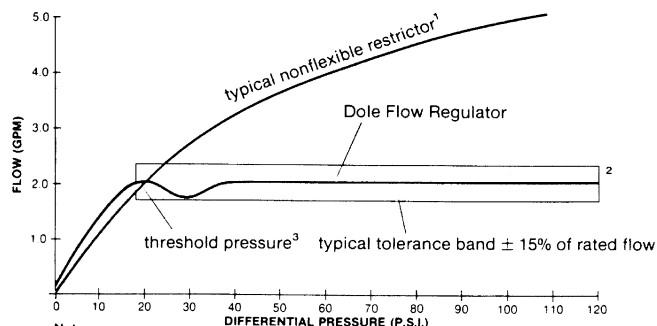

Operating Principle:

