

COMMERCIAL CONSTRUCTION | FIRE PROTECTION | HVAC | IRRIGATION
MINING | WATER & WASTE MANAGEMENT | OIL & GAS | POWER GENERATION

When **QUALITY,**
SERVICE and **PRICE**
MATTER MOST!



IRON CHECK VALVES

GATE VALVES | GLOBE VALVES | CHECK VALVES | BUTTERFLY VALVES



Located in the greater Toronto area, NCI Canada Inc. is an innovative, privately owned company that specializes in the development, manufacturing and distribution of high quality pipe, valves and fittings (PVF). With over 20 years of industry experience, we are recognized as one of Canada's leading master distributors of pipe, valves and fittings and are proud to service wholesale, retail and OEM customers.



VISIT US ONLINE TODAY AT
NCICanada.com

The CKVA-FCI1330 is an NCI Canada class 125 rated (200 CWP) iron body check valve with flanged ends. These cast iron swing check valves have a bolted bonnet and are bronze mounted. The CKVA-FCI1330 iron body check valve meets MSS-SP71 standards and has a renewable disc and seat*.

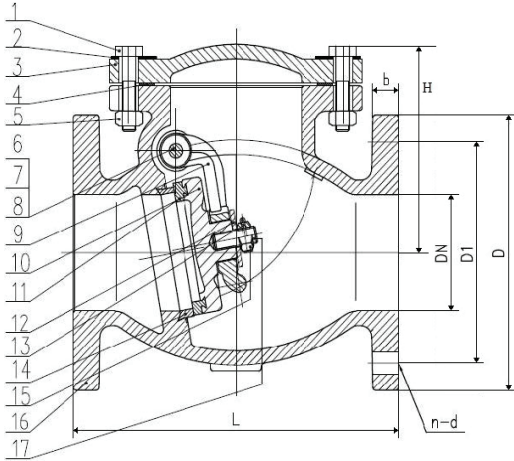

Check Valve Material Specifications

NO.	PART NAME	MATERIAL	MATERIAL STANDARD
1	Bolts	Steel	ASTM A307 B
2	Identification Plate	Aluminum	COMMERCIAL
3	Bonnet	Cast Iron	ASTM A126 B
4	Body Gasket	Graphite	NON ASBESTOS
5	Nuts	Steel	ASTM A307 B
6	Side Plug	Brass	ASTM B16
7	Gasket	Fiber	NON ASBESTOS
8	Hanger Pin	Brass	ASTM B16
9	Hanger	Ductile Iron	ASTM A536
10	Disc	Cast Iron	ASTM A126 B
11	Disc Ring	Cast Bronze	ASTM B62
12	Washer	Steel	ASTM A307 B
13	Split Pin	Stainless Steel	ASTM 420 S42000
14	Seat Ring	Cast Bronze	ASTM B62
15	Nut	Steel	ASTM A307 B
16	Body	Cast Iron	ASTM A126 B
17	Bolt	Steel	ASTM A307 B

Valve Standard
Conforms to MSS SP-71

Flanged Ends
ANSI B16.1 Class 125

Working Pressure
125S, 200 WOG

Face to face Dimensions
Conforms to ANSI B16.10 (125 Lb)

Iron Check Valve Dimensions

Size DN	mm	51	63.5	76	102	127	152	203	254	305
	inch	2	2 ½	3	4	5	6	8	10	12
L	mm	203.2	215.9	241.3	292.1	330.2	355.6	495.3	622.3	698.5
	inch	8.0	8.5	9.5	11.5	13.0	14.0	19.5	24.5	27.5
D	mm	152	178	191	229	254	279	343	406	483
	inch	6.0	7.0	7.5	9.0	10.0	11.0	13.5	16.0	19.0
D1	mm	120.7	139.7	152.4	190.5	215.9	241.3	298.5	362	431.8
	inch	4.8	5.5	6.0	7.5	8.5	9.5	11.8	14.3	17.0
b	mm	15.8	17.5	19	23.9	23.9	25.4	28.5	30.2	31.8
	inch	0.62	0.69	0.75	0.94	0.94	1.00	1.12	1.19	1.25
n-d	mm	4-19	4-19	4-19	8-19	8-22	8-22	8-22	12-25	12-25
	inch	4-3/4	4-3/4	4-3/4	8-3/4	8-7/8	8-7/8	8-7/8	12-1	12-1
Weight	lb	25.35	38.14	46.30	79.37	121.25	156.53	266.76	432.11	639.34
	Kg	11.50	17.3	21.0	36.0	55.0	71.0	121.0	196	290

©2017 NCI Canada Inc., Oakville, ON, Canada. All rights reserved. The iron check valve information and its contents hereof are proprietary to NCI Canada Inc. Any unauthorized reproduction or disclosure, in whole or in part is strictly prohibited. The iron check valve material in this catalog / brochure is for general information and shall not be used for specific performance data and material selection without first consulting with NCI Canada Inc. NCI Canada reserves the right to change the enclosed iron check valve information without notice. NCI Canada does not accept any liability or damages arising from the use of the iron check valve information within this brochure. All trademarks and registered trademarks are owned by their respective companies.
NOT TO BE USED FOR RECIPROCATING AIR COMPRESSOR APPLICATIONS. *with proper machining capability



Headquarters and Central Warehouse

Address: 2305 Wyecroft Road
Oakville, Ontario
Canada L6L 6R2

Local Tel: (905) 727-5545
Toll-Free: (800) 268-3509
Fax: (905) 727-4088

Web: www.ncicanada.com
Email: sales@ncicanada.com