

Section 9

Fuseal 25/50™ Corrosive Waste Piping System



Glossary

S	= Fuseal Electrofusion Socket
SPG	= Spigot End (same dimension as pipe outside diameter)
FT	= Female Thread (Straight)
MT	= Male Thread (Straight)
MPT	= Male Pipe Thread
FPT	= Female Pipe Thread

Product Line	Description	Discount
07	Fusion Accessories	_____
57	PVDF Sch. 40 pipe	_____
58	PVDF Fusion Fittings-Molded	_____
59	PVDF Fusion Fittings-Fab	_____

The technical information given in this publication implies no warranty of any kind and is subject to change without notice. Please consult our Terms and Conditions of Sale.

Not for Use with Compressed Air or Gases

DO NOT TEST with Air or Air over Water

GF Piping Systems DOES NOT RECOMMEND the use of thermoplastic piping products for systems to transport or store compressed air or gases, or the testing of thermoplastic piping systems with compressed air or gases in above or below ground locations. The use of GF Piping products in compressed air or gas systems automatically voids the warranty for such products, and their use against our recommendation is entirely the responsibility and liability of the installer. GF will not accept responsibility for damage or impairment from its products, or other consequential or incidental damages caused by misapplication, incorrect assembly, and/or exposure to harmful substances or conditions.

For more information about any of our product lines, please call (800) 423-2686.



Fuseal 25/50 PVDF Pipe

62



Fuseal 25/50 PVDF Fusion Fittings

63



Fuseal 25/50 PVDF Cleanouts and Floor Drains

69



Fuseal 25/50 PVDF Traps

72



Fuseal 25/50 PVDF Fusion Accessories

74

Fuseal 25/50 PVDF Pipe

A



Schedule 40 PVDF

20' lengths available upon request

Size (inch)	lengths (ft)	Part No.	USD	Lift Qty (ft)	avg. od (inch)	min. wall (inch)
1 1/2	10	* 37C013015	50.78	1800	1.900	0.145
2	10	* 37C013020	70.98	1050	2.375	0.154
3	10	* 37C013030	141.97	580	3.500	0.216
4	10	* 37C013040	206.22	510	4.500	0.237
6	10	* 37C013060	544.04	220	6.625	0.280

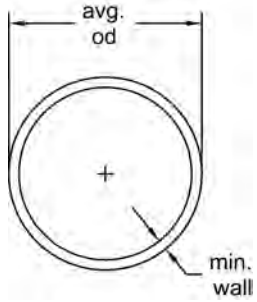

Fuseal 25/50 PVDF Fusion Fittings

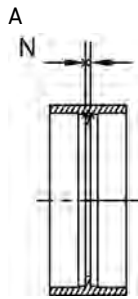

Coupling (S x S)

Size (inch)	Part No.	USD	Pack Qty	N (inch)
1 1/2	588001	47.05	8	0.13
2	588002	53.58	6	0.13
3	588003	73.37	3	0.19
4	588004	106.74	2	0.19
6	588006	136.79	2	0.19

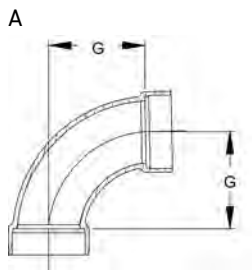

1/4 Bend (91.2°) - Long Sweep (S x S)

Size (inch)	Part No.	USD	Pack Qty	G (inch)
1 1/2	588276	98.96	4	2.75
2	588277	140.93	4	3.25
3	588278	275.65	1	4.06
4	588279	568.91	1	4.94
6	*588256F	1,929.53	1	11.00

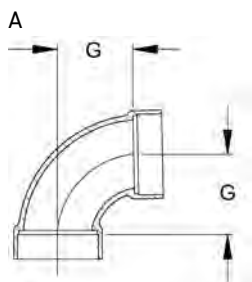

1/4 Bend (91.2°) - Short Sweep (S x S)

Size (inch)	Part No.	USD	Pack Qty	G (inch)
1 1/2	589276	92.33	4	1.75
2	589277	125.39	4	2.31
3	589278	289.12	1	3.06
4	589279	560.62	1	3.88

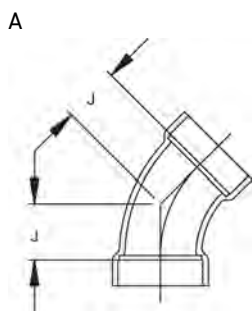

1/8 Bend (45°) (S x S)

Size (inch)	Part No.	USD	Pack Qty	J (inch)
1 1/2	589501	87.36	4	1.13
2	589502	104.66	4	1.50
3	589503	297.41	1	1.75
4	589504	478.76	1	2.19
6	*588506F	1,014.51	1	6.25

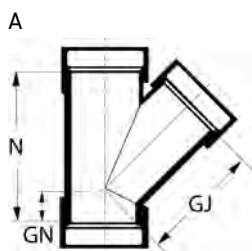

45° Wye (S x S x S)

Size (inch)	Part No.	USD	Pack Qty	GJ (inch)	GN (inch)	N (inch)
1 1/2	585301	140.93	4	2.88	1.13	4.00
2	585302	224.87	4	3.63	1.38	5.00
3	585303	478.76	1	5.00	1.63	6.63
4	585304	766.84	1	6.38	1.88	8.25
6	*588306F	1,154.40	1	12.19	6.19	18.38

A

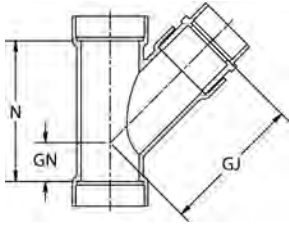
45° Wye - Reducing (S x S x S)

Size (inch)	Part No.	USD	Pack Qty	GJ (inch)	GN (inch)	N (inch)
2 x 2 x 1 1/2	* 588915	214.51	4	5.06	1.38	5.00
3 x 3 x 1 1/2	* 588917	305.70	1	6.06	0.88	5.00
3 x 3 x 2	588916	305.70	1	4.63	0.88	5.00
4 x 4 x 2	588918	668.39	1	5.56	0.38	5.06
4 x 4 x 3	588919	668.39	1	7.47	1.88	8.25
6 x 6 x 3	* 588330T	1,681.87	1	9.94	1.75	12.38
6 x 6 x 4	* 588331T	1,681.87	1	10.13	2.25	12.38

A

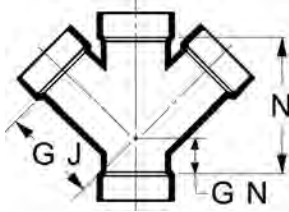
45° Wye - Double (S x S x S x S)

Size (inch)	Part No.	USD	Pack Qty	GJ (inch)	GN (inch)	N (inch)
1 1/2	589380	267.36	4	3.50	1.13	4.63
2	589381	470.47	4	4.00	1.38	5.38
3	589382	816.58	1	5.00	1.63	7.63
4	589383	1,071.50	1	6.38	1.88	9.25
6	* 585396F	1,832.12	1	12.19	6.19	18.38

A

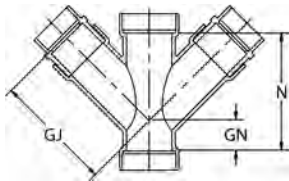
45° Wye - Double Reducing (S x S x S x S)

Size (inch)	Part No.	USD	Pack Qty	GJ (inch)	GN (inch)	N (inch)
2 x 2 x 1 1/2 x 1 1/2	* 585381	676.68	2	5.44	1.13	5.38
3 x 3 x 1 1/2 x 1 1/2	* 585382	866.32	1	6.50	1.63	7.63
3 x 3 x 2 x 2	* 585383	414.51	1	6.50	1.63	7.63
4 x 4 x 2 x 2	* 585384	1,632.12	1	7.50	1.88	9.25
4 x 4 x 3 x 3	* 585385	1,780.31	1	7.47	1.88	8.25
6 x 6 x 3 x 3	* 585387T	2,769.95	1	15.38	6.25	12.38
6 x 6 x 4 x 4	* 585388T	2,769.95	1	15.38	6.25	12.38

A

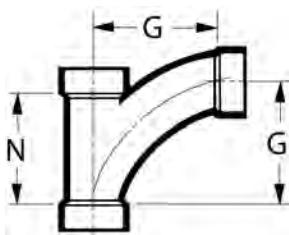
Long Turn Tee Wye (91.2°) (S x S x S)

Size (inch)	Part No.	USD	Pack Qty	G (inch)	N (inch)
1 1/2	584301	196.89	4	3.94	3.50
2	584302	280.83	4	5.13	4.44
3	584303	741.97	1	7.56	6.50
4	584304	1,170.98	1	10.00	8.50

A

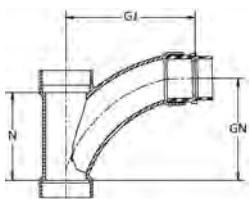
Long Turn Tee Wye (91.2°) - Reducing (S x S x S)

Size (inch)	Part No.	USD	Pack Qty	GJ (inch)	GN (inch)	N (inch)
2 x 2 x 1 1/2	* 584320	267.36	2	6.56	5.16	4.44
3 x 3 x 1 1/2	* 584321	370.98	1	9.06	7.59	6.50
3 x 3 x 2	* 584322	370.98	1	9.06	7.59	6.50
4 x 4 x 2	* 584323	750.26	1	10.95	9.84	8.50
4 x 4 x 3	* 584324	750.26	1	10.91	9.84	8.50

A

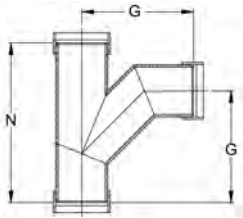

Combo Wye & 1/8 Bend (90°) (S x S x S)

Size (inch)	Part No.	USD	Pack Qty	G (inch)	N (inch)
6	*589306T	2,390.67	1	14.25	20.38

A

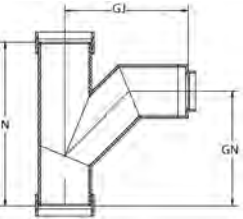

Combo Wye & 1/8 Bend (90°) - Reducing (S x S x S)

Size (inch)	Part No.	USD	Pack Qty	GJ (inch)	GN (inch)	N (inch)
6 x 6 x 3	*589330T	2,036.27	1	9.88	9.88	12.38
6 x 6 x 4	*589331T	2,036.27	1	10.88	10.81	12.38

A

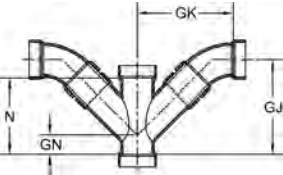

Combo Wye (90°) - Double (S x S x S x S)

Size (inch)	Part No.	USD	Pack Qty	GJ (inch)	GK (inch)	GN (inch)	N (inch)
1 1/2	*587191	445.60	1	5.63	5.63	1.13	4.63
2	*587192	668.39	1	6.69	6.81	1.38	5.38
3	*587193	1,425.91	1	7.91	8.03	1.63	7.63
4	*587194	2,184.46	1	9.60	10.13	1.88	9.25
6	*587196F	3,420.73	1	19.13	19.19	6.19	18.38

A

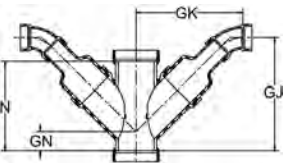

Combo Wye (90°) - Double Reducing (S x S x S x S)

Size (inch)	Part No.	USD	Pack Qty	GJ (inch)	GK (inch)	GN (inch)	N (inch)
2 x 2 x 1 1/2 x 1 1/2	*587181	834.20	1	8.36	8.11	1.13	5.38
3 x 3 x 1 1/2 x 1 1/2	*587182	1,039.38	1	9.67	9.15	1.63	7.63
3 x 3 x 2 x 2	*587183	1,112.95	1	9.94	9.81	1.63	7.63
4 x 4 x 2 x 2	*587184	1,731.61	1	11.34	10.96	1.88	9.25
4 x 4 x 3 x 3	*587185	1,953.37	1	11.52	11.38	1.88	9.25
6 x 6 x 3 x 3	*587187T	4,038.34	1	9.88	9.88	1.75	12.38
6 x 6 x 4 x 4	*587188T	4,038.34	1	10.88	10.81	2.25	12.38

A

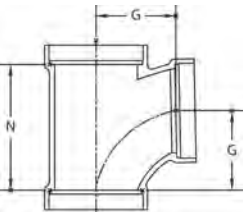

Sanitary Tee (91.2°) (S x S x S)

Size (inch)	Part No.	USD	Pack Qty	G (inch)	N (inch)
1 1/2	589151	135.75	4	1.75	2.75
2	589152	206.22	4	2.31	3.69
3	589153	429.02	1	3.06	4.88
4	589154	668.39	1	3.88	6.13

A

Sanitary Tee (91.2°) - Reducing (S x S x S)

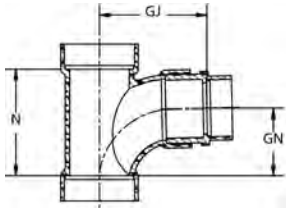

Size (inch)	Part No.	USD	Pack Qty	GJ (inch)	GN (inch)	N (inch)
2 x 2 x 1 1/2	* 589915	214.51	4	3.74	2.34	3.69
3 x 3 x 1 1/2	* 589917	322.28	1	4.56	3.09	4.88
3 x 3 x 2	* 589916	280.83	1	4.56	3.09	4.88
4 x 4 x 2	* 589918	1,368.91	1	5.00	3.88	6.13
4 x 4 x 3	* 589919	1,368.91	1	4.97	3.88	6.13

A

Sanitary Tee (91.2°) - Double (S x S x S x S)

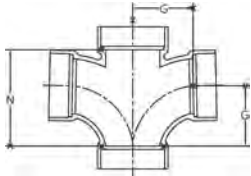

Size (inch)	Part No.	USD	Pack Qty	G (inch)	N (inch)
2	589182	422.80	4	2.31	3.69
3	589183	793.78	1	3.06	4.88

A

Sanitary Tee (91.2°) - Double Reducing (S x S x S x S)

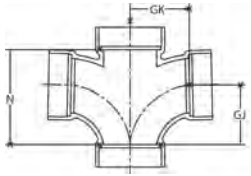

Size (inch)	Part No.	USD	Pack Qty	GJ (inch)	GK (inch)	N (inch)
2 x 2 x 1 1/2 x 1 1/2	* 589115	608.29	4	2.31	3.75	3.69
3 x 3 x 1 1/2 x 1 1/2	* 589117	1,031.09	1	3.06	4.56	4.88
3 x 3 x 2 x 2	* 589116	1,075.65	1	3.06	4.56	4.88

A

Pipe Increaser (SPG x SPG)

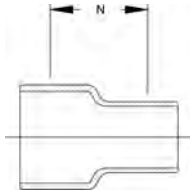

Size (inch) (inch)	Part No.	USD	Pack Qty	N (inch)
2 x 1 1/2	588421	62.69	6	3.19
3 x 1 1/2	588431	135.75	4	3.62
3 x 2	588432	157.51	4	3.50
4 x 2	588442	197.93	3	4.00
4 x 3	588443	206.22	2	3.68

A

Increaser Bushing (SPG x S)

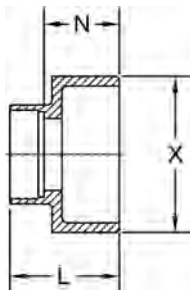

Size (inch) (inch)	Part No.	USD	Pack Qty	L (inch)	N (inch)	X (inch)
2 x 1 1/2	588752	64.35	6	2.31	1.43	2.38
3 x 1 1/2	588762	129.53	4	2.26	1.50	3.50
3 x 2	588754	155.44	4	2.38	1.50	3.50
4 x 2	588758	214.51	2	2.00	1.13	4.50
4 x 3	588756	239.38	2	2.03	1.09	4.50
6 x 4	588446	618.65	1	2.19	1.28	6.63

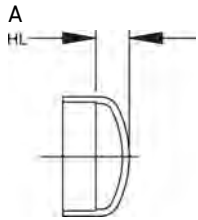

Cap (S)

Size (inch)	Part No.	USD	Pack Qty	HL (inch)
1 ½	588081	64.35	4	0.65
2	588082	72.54	4	0.75
3	588083	157.51	2	1.62
4	588084	214.51	2	2.11
6	588086	289.12	1	1.58

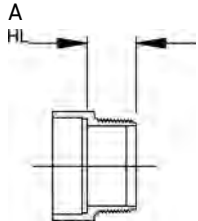

Male Adapter (S x MPT)

Size (inch)	Part No.	USD	Pack Qty	HL (inch)
1 ½	* 589871	54.40	4	1.19
2	* 589872	74.20	4	1.25
3	* 589873	157.51	2	1.84
4	* 589874	206.22	2	2.00
6	* 589876	495.34	1	3.50

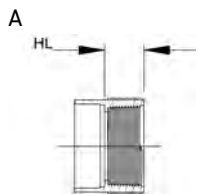

Female Adapter (S x FPT)

Size (inch)	Part No.	USD	Pack Qty	HL (inch)
1 ½	* 589891	54.40	4	1.13
2	* 589892	74.20	4	1.16
3	* 589893	157.51	2	1.72
4	* 589894	206.22	2	1.84
6	* 589896	495.34	1	3.25

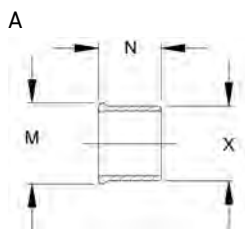

Glass Adapter (SPG x Glass Pipe Bead)

Compression Coupling and Clamp available from Glass Vendor

Size (inch)	Part No.	USD	Pack Qty	M (inch)	N (inch)	X (inch)
1 ½	* 588411	54.40	4	2.06	2.00	1.90
2	* 588412	74.20	4	2.58	2.00	2.38
3	* 588413	157.51	2	3.69	2.50	3.50
4	* 588414	206.22	2	4.84	2.50	4.50
6	* 588416	495.34	1	7.12	3.00	6.63

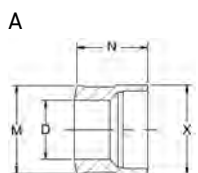

Iron Pipe Adapter (S x Iron Pipe Bead)

Silicon Iron Clamp available from Iron Pipe Vendor

Size (inch)	Part No.	USD	Pack Qty	D (inch)	M (inch)	N (inch)	X (inch)
1 ½	* 589431	54.40	4	1.50	2.25	1.88	2.25
2	* 589432	74.20	4	2.00	2.81	2.00	2.75
3	* 589433	157.51	2	3.00	3.81	2.63	3.95
4	* 589434	206.22	2	4.00	4.81	2.63	5.01

A

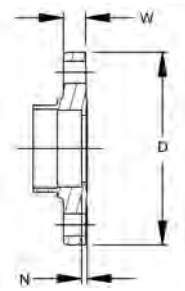

Flange - Solid ANSI 150 lb. Pattern (S)

Size (inch)	Part No.	USD	Pack Qty	# holes	bolt hole dia. (inch)	bolt cir. dia. (inch)	D (inch)	N (inch)	W (inch)
1 ½	588921	197.93	1	4	1	4	5.00	0.16	0.66
2	588922	214.51	1	4	1	5	6.00	0.14	0.75
3	588923	379.27	1	4	1	6	7.50	0.16	0.94
4	588924	470.47	1	8	1	8	9.00	0.16	1.14
6	588926	626.94	1	8	1	10	10.94	0.25	1.02

A

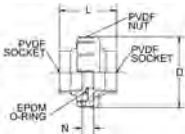

Union (PVDF x PVDF)/PVDF Nut (S x S)

Size (inch)	EPDM Part No.	USD	FKM Part No.	USD	Pack Qty	D (inch)	L (inch)	N (inch)
1 ½	*588261	102.28	*588271	105.70	2	3.75	3.38	0.63
2	*588262	129.53	*588272	140.93	2	4.63	3.75	0.75
3	*588263	214.51	*588273	231.09	2	6.75	4.68	0.90
4	*588264	313.99	*588274	330.57	2	8.50	5.54	1.00

A

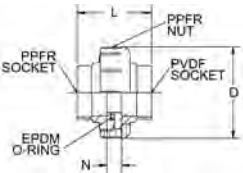

Union (PPFR x PVDF)/PPFR Nut (S x S)

Size (inch)	EPDM Part No.	USD	FKM Part No.	USD	Pack Qty	D (inch)	L (inch)	N (inch)
1 ½	*588281	74.20	*589291	87.36	2	3.75	3.38	0.63
2	*588282	107.77	*589292	116.06	2	4.63	3.75	0.75
3	*588283	189.64	*589293	214.51	2	6.75	4.68	0.90
4	*588284	297.41	*589294	313.99	2	8.50	5.54	1.00

A

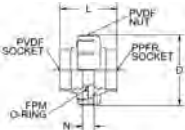

Union (PVDF x PPFR)/PVDF Nut (S x S)

Size (inch)	EPDM Part No.	USD	FKM Part No.	USD	Pack Qty	D (inch)	L (inch)	N (inch)
1 ½	*589281	74.20	*588291	87.36	2	3.75	3.38	0.63
2	*589282	107.77	*588292	116.06	2	4.63	3.68	0.75
3	*589283	189.64	*588293	214.51	2	6.75	4.75	0.90
4	*589284	297.41	*588294	313.99	2	8.50	5.54	1.00

Fuseal 25/50 PVDF Cleanouts and Floor Drains

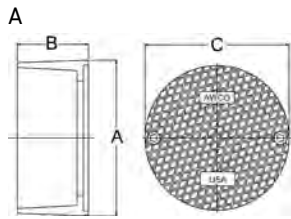

Nickel Bronze Floor Cleanout Housing

Size (inch)	Part No.	USD	A (inch)	B (inch)	C (inch)
All	* 527715A	432.12	6.13	2.81	5.70

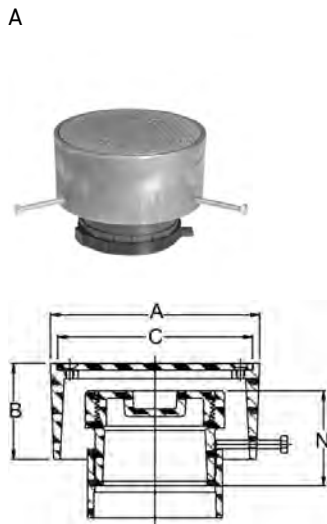

Nickel Bronze Floor Cleanout Assembly (S)

2" adjustment

Size (inch)	Part No.	USD	Pack Qty	A (inch)	B (inch)	C (inch)	N (inch)
3	* 588713A	741.97	1	6.13	2.81	5.70	2.78
4	* 588714A	824.87	1	6.13	2.81	5.70	3.06

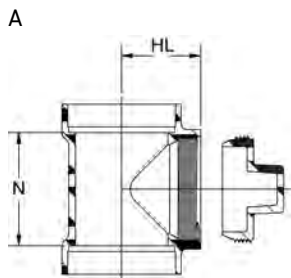

Cleanout Tee with Plug (S x S x FT)

Size (inch)	Part No.	USD	Pack Qty	HL (inch)	N (inch)
1 1/2	588114A	247.67	2	1.82	2.12
2	588115A	297.41	2	2.13	2.74
3	588116A	585.49	2	2.63	3.75
4	588117A	989.64	2	3.38	5.00
6	* 588118AF	3,708.81	1	7.75	18.00

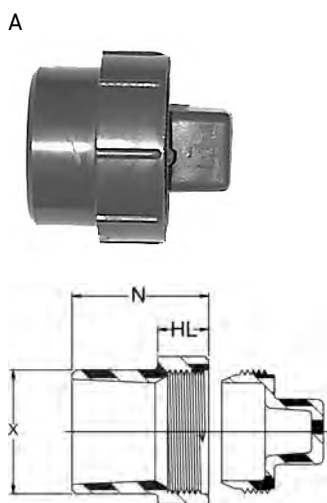

Cleanout Adapter with Plug (Spg x FT)

Size (inch)	Part No.	USD	Pack Qty	HL (inch)	N (inch)	X (inch)
1 1/2	588701	72.54	2	0.78	2.09	1.90
2	588702	93.99	2	0.78	2.22	2.38
3	588703	206.22	2	1.09	2.66	3.50
4	588704	267.36	2	1.13	2.94	4.50
6	588706	668.39	1	1.31	2.63	6.63

A



Countersink Plug for Cleanout (MT)

Size (inch)	Part No.	USD	Pack Qty	L (inch)	Q (inch)
3	* 589063	157.51	1	1.03	1.31
4	* 589064	219.69	1	1.16	1.63

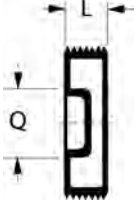

A



Floor Drain (S)

Size (inch)	Part No.	USD	Pack Qty	A (inch)	B (inch)	C (inch)	D (inch)	E (inch)	F (inch)
3	589750	948.19	1	8.50	12.00	1.63	5.25	3.63	4.31
4	* 589751	1,047.67	1	8.50	12.00	1.63	5.25	3.63	4.31

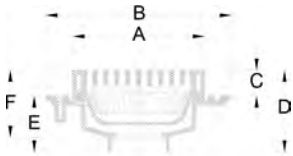

A



Replacement Strainer for Floor Drain

Size (inch)	Part No.	USD
All	* 587502	155.44

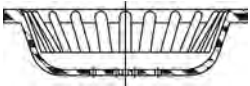

A

Replacement Grate for Floor Drain



Size (inch)	Part No.	USD
All	* 587503	155.44

A

Anti-splash Funnel for Floor Drain

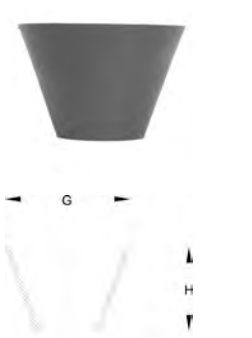

Size (inch)	Part No.	USD	G (inch)	H (inch)
All	* 587777	206.22	6	

Fuseal 25/50 PVDF Traps

A

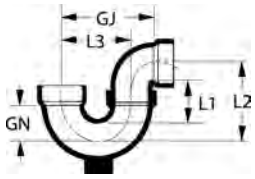

P-Trap with Cleanout (S x S)

1-1/2" - 4" U-Bend Joint must be fused in the field

Size (inch)	Part No.	USD	Pack Qty	GJ (inch)	GN (inch)	L1 (inch)	L2 (inch)	L3 (inch)
1 1/2	* 588201	330.57	2	4.71	1.68	2.06	3.64	3.50
2	* 588202	453.89	2	6.94	2.44	2.71	4.75	5.06
3	* 588203	1,031.09	2	8.88	2.79	3.41	6.43	6.75
4	* 588204	1,698.45	2	10.75	3.88	3.88	8.06	8.50

A

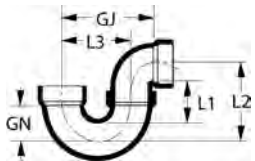

P-Trap (S x S)

6" U-Bend Joint is Factory Fused
1-1/2" - 4" U-Bend Joint must be fused in the field

Size (inch)	Part No.	USD	Pack Qty	GJ (inch)	GN (inch)	L1 (inch)	L2 (inch)	L3 (inch)
1 1/2	588991	313.99	2	4.71	1.68	2.06	3.64	3.50
2	588992	437.31	2	6.94	2.44	2.71	4.75	5.06
3	588993	1,031.09	2	8.88	2.79	3.41	6.43	6.75
4	588994	1,689.12	2	10.75	3.88	3.88	8.06	8.50
6	* 588996F	7,170.98	1	28.06	11.19	10.81	17.44	16.88

A

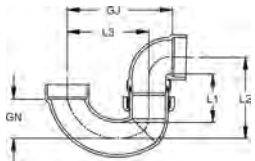

P-Trap with Union Connection (S x S)

Size (inch)	Part No.	USD	Pack Qty	GJ (inch)	GN (inch)	L1 (inch)	L2 (inch)	L3 (inch)
1 1/2	* 588211	420.73	2	4.84	1.68	2.38	4.00	3.50
2	* 588212	618.65	2	6.50	2.43	2.84	4.88	5.06

A

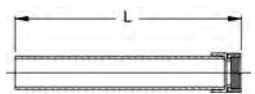

Swivel Sink Strainer Adapter with Gasket (SPG x FT)

Size (inch)	Part No.	USD	Pack Qty	L (inch)	N (inch)
1 1/2	* 589217	98.96	5	13.00	0.44

A



Replacement Gasket for Swivel Sink Strainer

Material: FKM

Size (inch)	Part No.	USD	Pack Qty
1 1/2	* 37X002100	11.61	5

A

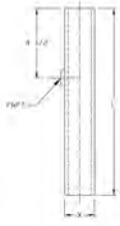

Trap Primer w/FPT Tap (SPG x SPG)

Size (inch)	Part No.	USD	L (inch)	X (inch)	FPT (inch)
1 ½	* 587201	330.57	12	1.90	½
2	* 587202	412.44	12	2.38	½
3	* 587203	478.76	12	3.50	½
4	* 587204	577.20	12	4.50	½
6	* 587206	775.13	12	6.63	¾

Fuseal 25/50 PVDF Fusion Accessories

B



Loose Coil

Size (inch)	Part No.	USD	Pack Qty
1 ½	* 37C160801	8.29	10
2	* 37C160802	8.29	10
3	* 37C160803	9.95	10
4	* 37C160804	9.95	10
6	* 37C160806	14.92	10

B



Metal Clamp

Size (inch)	Part No.	USD	weight (lb)	Pack Qty
1 ½	* 37Z000150	64.35	0.130	10
2	* 37Z000200	64.35	0.161	10
3	* 37Z000300	64.35	0.340	10
4	* 37Z000400	61.76	0.399	1
6	* 37Z000600	80.93	0.399	1

GF Piping Systems

Corrosive Waste Piping System
Specification Submittal Data Sheet
Fuseal 25/50™ PVDF Pipe and Fittings

Pipe

Pipe will be manufactured to the dimensions and tolerances of ASTM F1673. The polyvinylidene fluoride (PVDF) material conforms to ASTM D3222 and will also have a flame spread of less than 25 and smoke developed index of less than 50 when tested in accordance to ASTM E84, UL723 and NFPA 255. The pipe will conform to UPC®, the City of Los Angeles and the Commonwealth of Massachusetts standards.

- PVDF Sch.40 Pipe - 10 ft. Lengths

Fittings

Molded and fabricated fittings will be manufactured to the dimensions and tolerances of ASTM F1673. Molded fitting patterns will conform to ASTM D3311. The polyvinylidene fluoride (PVDF) material will conform to ASTM D3222 and will also have a flame spread of less than 25 and smoke developed index of less than 50 when tested in accordance to ASTM E84, UL723 and NFPA 255. The molded fittings will conform to UPC®, the fabricated fittings to IAPMO, all fittings to the City of Los Angeles and the Commonwealth of Massachusetts standards.

- PVDF Sch.40 Molded
- PVDF Sch.40 Fabricated

Joining

Pipe and fittings are joined by electrofusion joints and consist of a PVDF jacked wire with duplex plug connection.

- Electrofusion

Job Name: _____

Job Location: _____

Engineer: _____

Contractor: _____

Representative: _____

GF Piping Systems

Corrosive Waste Piping System

Specification Submittal Data Sheet

Fuseal 25/50™ PVDF Nickel Bronze Floor Cleanout

Floor Cleanout

Corrosion resistant finished floor cleanout is manufactured from polyvinylidene fluoride conforming to ASTM D3222 and will also have a flame spread of less than 25 and smoke developed index of less than 50 when tested in accordance to ASTM E84, UL723 and NFPA 255. The fitting will conform to UPC®, the City of Los Angeles and the Commonwealth of Massachusetts standards. The assembly includes a molded cleanout, countersunk plug, an adjustable access housing and removable cover. The housing has approximately 2" of adjustment. The access housing and cover are cast from 12% nickel bronze. AWCO (Acid Waste Cleanout) and USA are cast on the top cover.

- Nickel Bronze Housing and Cover
- 3" PVDF Sch.40 Molded with Nickel Bronze Housing and Cover
- 4" PVDF Sch.40 Molded with Nickel Bronze Housing and Cover

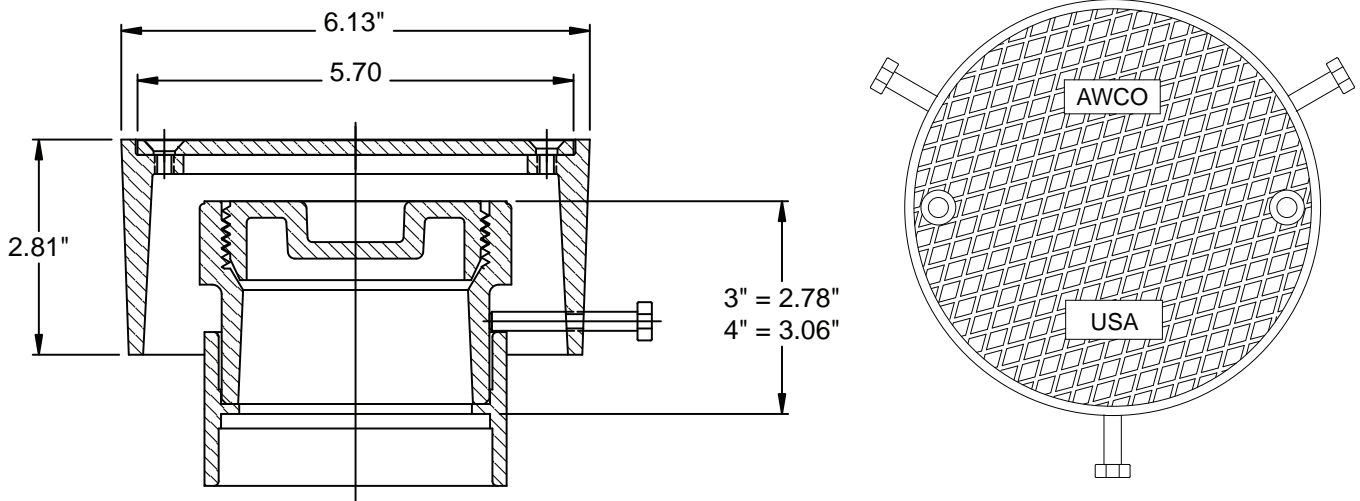

Job Name: _____

Job Location: _____

Engineer: _____

Contractor: _____

Representative: _____

UPC is a registered trademark of the International Association of Plumbing and Mechanical Officials

GF Piping Systems

Corrosive Waste Piping System
 Specification Submittal Data Sheet
 Fuseal 25/50™ PVDF Floor Drain

Floor Drain

Fixed height, moderate traffic floor drain with 8" diameter grate, sediment strainer and removable flashing collar that is manufactured from polyvinylidene fluoride (PVDF) conforming to ASTM D3222 and will also have a flame spread of less than 25 and smoke developed index of less than 50 when tested in accordance to ASTM E84, UL723 and NFPA 255. The floor drain will conform to UPC®, the City of Los Angeles and the Commonwealth of Massachusetts standards. The maximum flow rate is 44 GPM at 2" water level. The average failure load for the grate is 3,300 lbs with a maximum live load of 825 lbs. A boss is provided on the body of the drain which can be drilled and tapped to accept a primer line up to 1/2" NPT.

- 3" PVDF Sch.40 Molded Floor Drain
- 4" PVDF Sch.40 Molded Floor Drain
- Anti-Splash Funnel

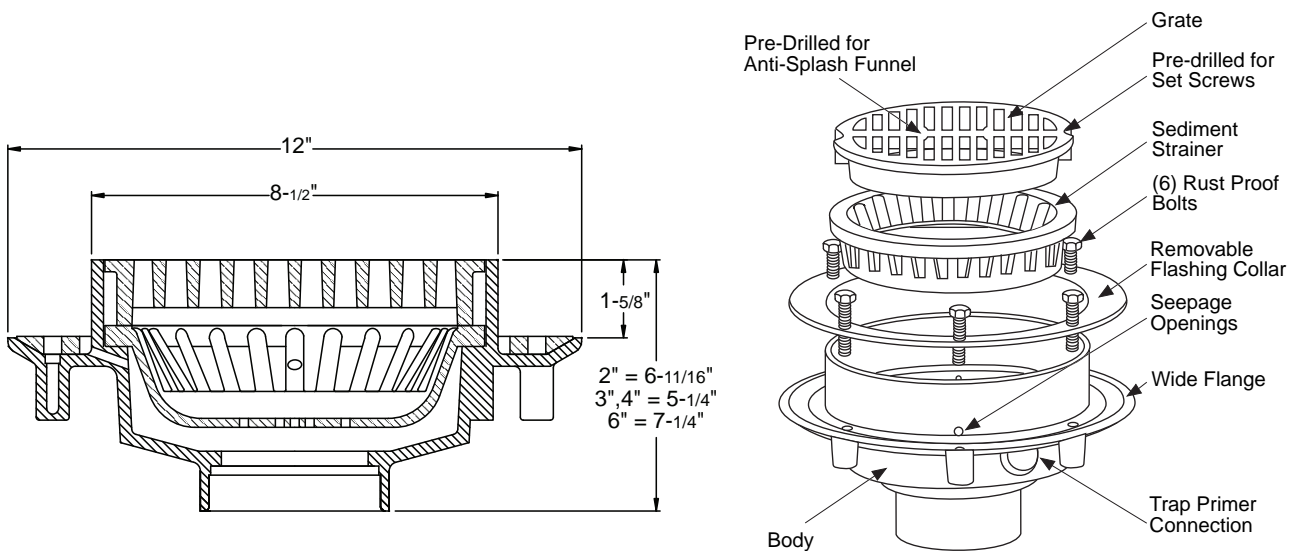

Job Name: _____

Job Location: _____

Engineer: _____

Contractor: _____

Representative: _____