

Distributed by:



WESTLUND / EMCO

WATER SOLUTIONS



We Are Certified and Award Winning

SPECIALISTS SERVING SPECIALISTS



Westlund Water Solutions is the leading Canadian distributor of pipes, valves, fittings, and all related equipment found 'inside the fence' for wastewater treatment plants, reservoirs, and pumping stations.



Ontario Office: 905-624-4575
Alberta Office: 780-577-8808
WaterSolutions@WestlundPVF.com
www.everythinginsidethefence.com

Phone: (704) 841-6000
Fax: (704) 841-6020

Regional Management List
now available online at:
<http://conbra.co/rmlist>

"Apollo" Flow Controls

"Apollo" Valves / Elkhart Products Corporation / EPC / LASCO FITTINGS, INC. / SHURJOINT®

VISIT
OUR NEW
Industrial Website

industrial.apollovalves.com

customer service (704) 841-6000



ASME B16.34 CLASS 600

Full Port Flange Valves

87A-F00 | 88A-F00 | 88L-F40

Distributed by:



WESTLUND/EMCO
WATER SOLUTIONS



"Apollo" Valves **5 YEAR WARRANTY**
DOMESTIC MADE

"Apollo" INDUSTRIAL
PRODUCTS

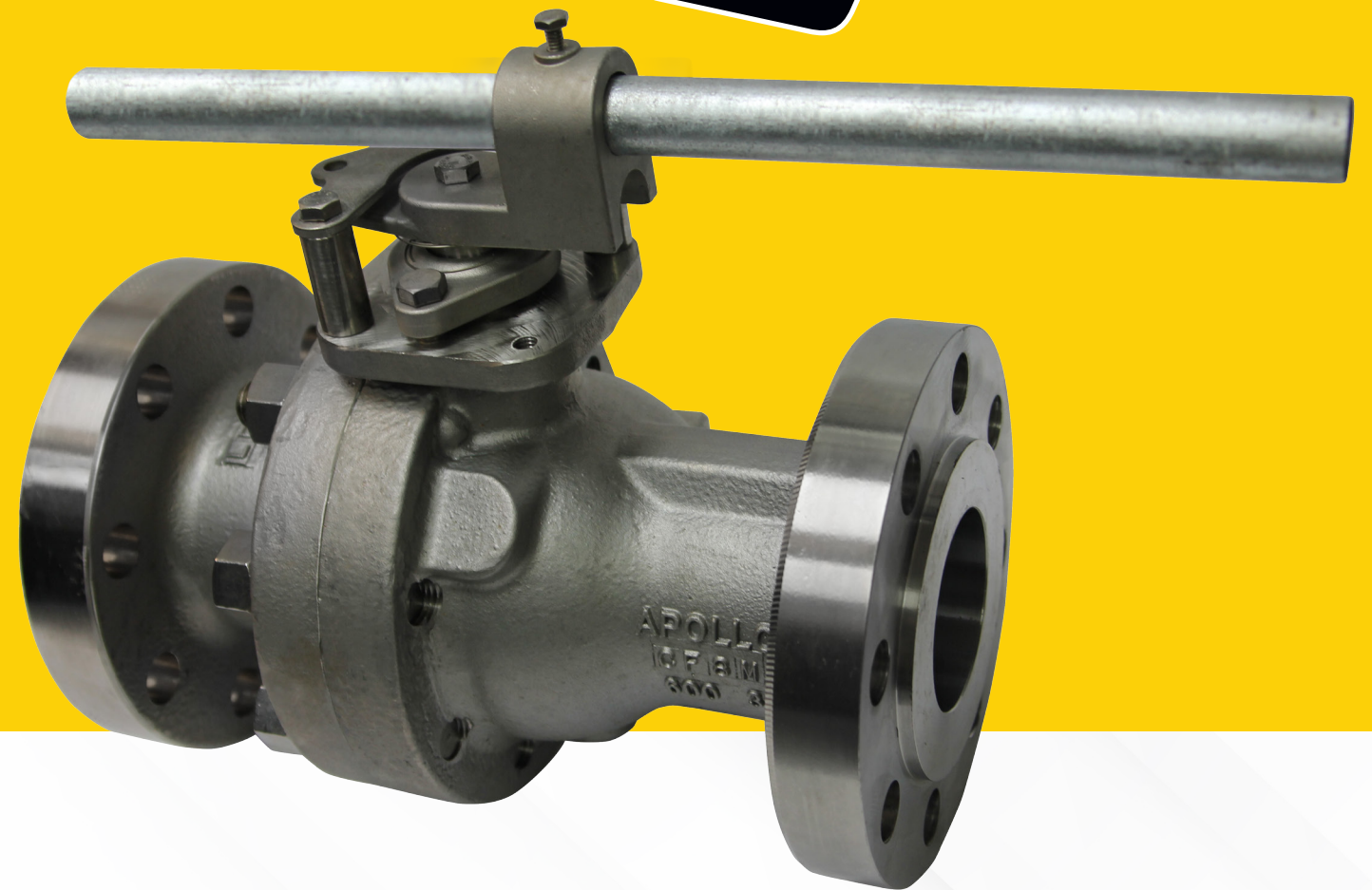

Apollo Valves, manufactured in the USA by Conbraco Industries, Inc., are designed, cast, machined, assembled and tested at our state-of-the-art facilities located in the USA. Vertical manufacturing operations assure better quality control, better cost control, and the shortest delivery lead times possible.



APOLLO® CLASS 600 FLANGE VALVES DELIVER HIGH PERFORMANCE FEATURES

Apollo® 87A-F, 88A-F, and 88L-F Series ASME Class 600 flange ball valves are available in Stainless Steel, Carbon Steel and Low Temp Carbon Steel in sizes 1" to 8" (DN25 to DN200). Other alloys such as Alloy 20, Hastelloy, Duplex & Super Duplex, Nickel & Nickel-Copper alloys and Titanium are available upon request.

STANDARD FEATURES

- Cast, machined, assembled, and tested in U.S.A.
- Fully compliant to ASME B16.34 & API 608
- Two Position Locking Device (Valves 6" and smaller)
- Valves with PTFE Stem Seals will be Adjustable Chevron Style
- ISO 5211 Mounting Pad Bolt Pattern
- SS Balls & Stems Available in Carbon Steel Valves (Standard in Low Temp CS & SS Valves)
- Slot Vented Ball for Thermal Expansion
- Rated up to 150 psig Saturated Steam

- Optional rating to 250 psig Saturated Steam (Requires the -24-80 Options or -38 Option)
- API 607 Fire Safe (Requires the -24-80 Options)
- Anti-static Grounded Ball and Stem
- Blow-out Proof Stem Design
- Cast Boss for Bleed / Drain Port
- Vacuum Service to 29 inches of Hg
- NACE MR0175 (2000) and MR0103 (2003) Compliance

Except where specifically noted all valves within this family of products include all listed features as standard.

STANDARD COMPLIANCE

- ASME B16.5 "Pipe Flanges and Flanged Fittings"
- ASME B16.10 "Face to Face Dimensions of Valves"
- ASME B16.34 "Valves - Flanged, Threaded, and Welding End"
- ASME B31.1 "Power Piping"
- ASME B31.3 "Chemical Plant and Petroleum Refinery Piping"
- ASME B31.8 "Gas Transmission and Distribution Piping Systems"
- API 607 "Fire Test - Soft Seated Quarter Turn Valves"

- API 608 "Ball Valves - Flanged, Threaded, and Welding End"
- MSS SP-25 "Standard Marking System for Valves"
- MSS SP-61 "Pressure Testing of Steel Valves"
- MSS SP-72 "Ball Valves with Flanged or Butt-welded Ends"
- NSF-372 Drinking Water System Components - Lead Content
- NSF/ANSI 61 (2010) Section 8, Annex F & G

Except where specifically noted all valves within this family of products complies with the requirements of this listed standard.

ASME CLASS 600 FLANGE VALVES

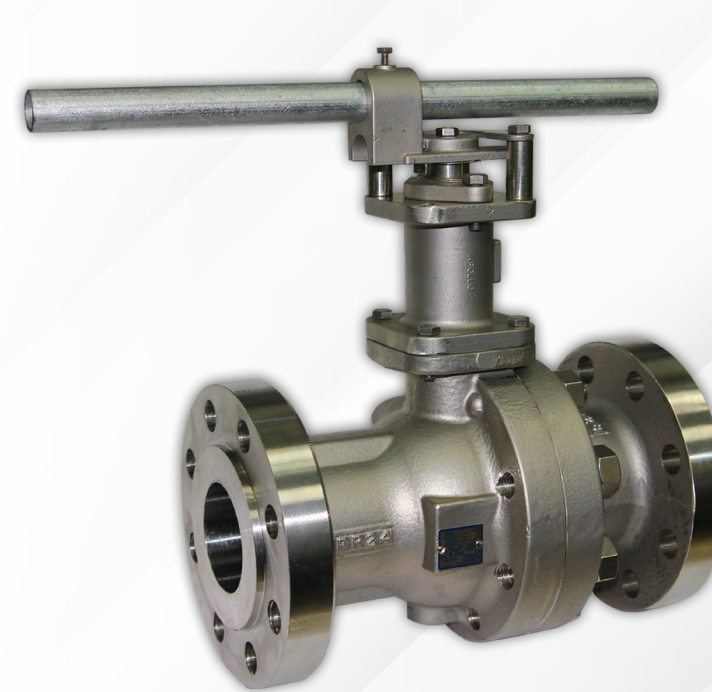

Class 600 Valve with 4" bonnet extension



Class 600 Valve with Actuator

STANDARD MATERIALS LIST

87A-F

PART	MATERIAL
Body	ASTM A351-CF8M
Retainer	ASTM A351-CF8M
Ball	ASTM A351-CF8M or ASTM A276 Type 316
Stem	ASTM A276 Type 316
Seats	Defined by Selected Seat Suffix*
Body Seals	Defined by Selected Seat Suffix*
Stem Seals	Defined by Selected Seat Suffix*
Stem Bearing	Defined by Selected Seat Suffix*
Grounding Spring	316 Stainless Steel
Packing Gland	ASTM A276 Type 316

* -80 (Multiseal) | -90 (Devlon) | -21 (UHMWPE) | -38 (PEEK)

See tech sheets for full product details

PART	MATERIAL
Stem Nut	ASTM A194 Grade 8
Lever & Grip	316 Stainless Steel w/ Vinyl Grip
Gland Plate	316 Stainless Steel
Stops	ASTM A276 Type 316
Lock Plate	302 or 304 Stainless Steel
Stop Screws	18-8 Stainless Steel
Gland Plate Screws	ASTM A193-B8
Body Joint Stud	ASTM A193-B8 Grade B8M
Body Joint Nut	ASTM A194-Grade 8
Lock Washer	302 or 304 Stainless Steel

88A-F

PART	MATERIAL
Body	ASTM A216-WCB
Retainer	ASTM A216-WCB
Ball	ASTM A216-WCB or ASTM A108
Stem	ASTM A108
Balance of components will be the same as 87A-F Material List	

88L-F

PART	MATERIAL
Body	ASTM A352-LCC
Retainer	ASTM A352-LCC
Ball	ASTM A351-CF8M or ASTM A276 Type 316
Stem	ASTM A276 Type 316
Balance of components will be the same as 87A-F Material List	

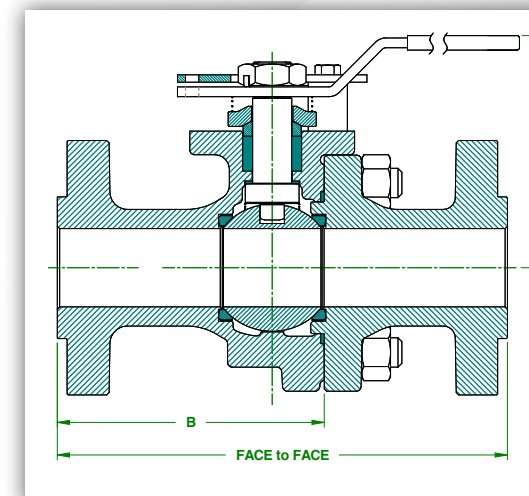

DIMENSIONS

SIZE	FACE to FACE	B	C	WT./LBS.
1"	8.50"	N/A*	3.99"	13
1.5"	9.50"	4.93"	5.03"	33
2"	11.50"	6.82"	6.06"	53
2.5"	13.00"	7.37"	6.63"	65
3"	14.00"	8.34"	8.55"	101
4"	17.00"	8.70"	11.20"	194
6"	22.00"	13.25"	14.17"	500
8"	26.00"	14.85"	N/A	920

*1" valve is a unibody design